

Double acting cylinders

| | |
|--|----------------------|
| DNB Double Acting - Single End Rod Type | |
| DNB..M Double Acting - Single End Rod Type (piston with magnet) | |
| DND Double Acting - Double End Rod Type | |
| DND..M Double Acting - Double End Rod Type (piston with magnet) | |
| DNN..N..A, DNN..N..B Adjustable Forward Stroke Cylinder | A:25mm B:50mm |
| DNN..M..A, DNN..M..B Adjustable Forward Stroke Cylinder (piston with magnet) | A:25mm B:50mm |

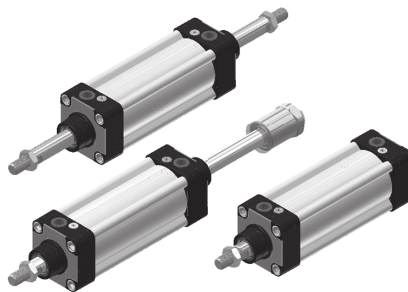

- DN Series cylinders according to ISO 6431 (Bore sizes φ 32 ~ φ 100)
- DN series is made with simple structure of high rigidity and strength.
- Pistons of complete series are made of light and wearproof plastic steel.
- Buffer pad for noise reduction.

Specification

| | | | | | | |
|-------------------------------|--|------|------|------|------|-------|
| Bore sizes of cylinder (mm) | φ 32 | φ 40 | φ 50 | φ 63 | φ 80 | φ 100 |
| Standard stroke (mm) | 25,50,75,100,125,150,175,200,250,300,350,400,450,500 | | | | | |
| The range of stroke (mm) | Stroke till 2500mm by request | | | | | |
| Power fluid | Filtered air with or without lubrication | | | | | |
| Material of cylinder barrel | Aluminium extrusion, Anodised 20 microns | | | | | |
| The range of pressure (MPa) | 0.1~1.03 | | | | | |
| The range of temperature (°C) | -10~+60 | | | | | |

How to order

| | | | | | | | |
|------------|--|--------------------------------|--|--|---|---|-------------------|
| DNN | 50 | N | 125 | B | FA - Y - LN01A | × 2 | |
| Type | Bore | Magnet | Stroke | Adjustable stroke | Accessory | Sensor switch | Quantity |
| DNB | 32—φ 32mm 40—φ 40mm 50—φ 50mm 63—φ 63mm 80—φ 80mm 100—φ 100mm | M: With magnet N: No magnet | 25—25mm 50—50mm 75—75mm 100—100mm 125—125mm 150—150mm 175—175mm 200—200mm 250—250mm 300—300mm 350—350mm 400—400mm 450—450mm 500—500mm | None: standard A: Adjustable 25mm B: Adjustable 50mm Note: this number can only be used for the adjustable type. | FA FB TC CA CB LB CG CD Y | LN01A: Suited for φ 32, φ 40 LN02A: Suited for φ 50, φ 63 LN03A: Suited for φ 80, φ 100 Note: 1.Can choose NPN or PNP type (3-Wire type, 24VDC). 2.Can choose plug-in cable. | 1: 1pc 2: 2pcs |
| DND | | | | | CA CB LB CG CD Y | | |
| DNN | | | | | CA CB LB CG CD Y | | |

How to order the seal kit

DNSK

| Bore | Seal kit |
|------|---------------------------------------|
| 32 | DNSK32 - Including No.12,13,14,15 |
| 40 | DNSK40 - Including No.12,13,14,15,16 |
| 50 | DNSK50 - Including No.12,13,14,15,16 |
| 63 | DNSK63 - Including No.12,13,14,15,16 |
| 80 | DNSK80 - Including No.12,13,14,15,16 |
| 100 | DNSK100 - Including No.12,13,14,15,16 |

DA

DP

DS

DQ

DB

DN

BN

ST

NT

DU

DJ

TA

GP

GS

GM

GT

RT

CT

CH

● Bore φ 32, φ 40

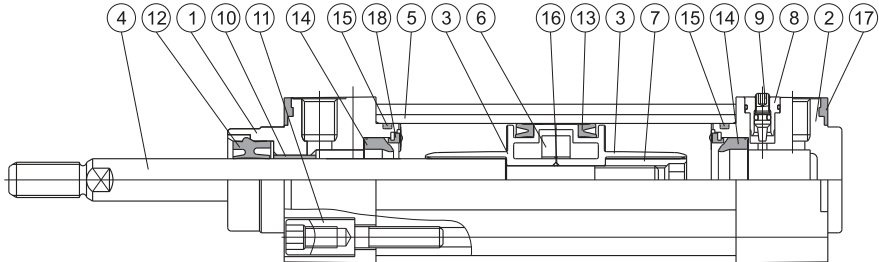

Parts List

| No. | part name | Quantity | No. | part name | Quantity | No. | part name | Quantity |
|-----|---------------|----------|-----|-----------------|----------|-----|-----------------|----------|
| 1 | Rod cover | 1 | 7 | Piston nut | 1 | 13 | Piston packing | 2 |
| 2 | Head cover | 1 | 8 | Cushion needle | 2 | 14 | Cushion packing | 2 |
| 3 | Piston | 2 | 9 | Cushion plug | 2 | 15 | Cylinder gasket | 2 |
| 4 | Piston rod | 1 | 10 | Oilless bearing | 1 | 16 | Piston gasket | 1 |
| 5 | Cylinder tube | 1 | 11 | Tie bolt | 8 | 17 | Dust cover | 2 |
| 6 | Magnet | 1 | 12 | Rod packing | 1 | 18 | Bumper | 2 |

● Bore φ 50, φ 63, φ 80, φ 100

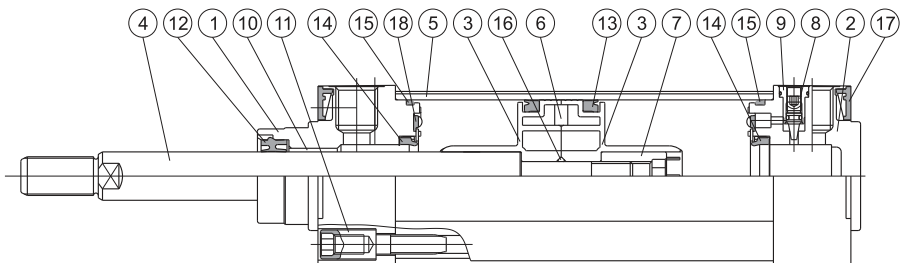

Parts List

| No. | part name | Quantity | No. | part name | Quantity | No. | part name | Quantity |
|-----|---------------|----------|-----|-----------------|----------|-----|-----------------|----------|
| 1 | Rod cover | 1 | 7 | Piston nut | 1 | 13 | Piston packing | 2 |
| 2 | Head cover | 1 | 8 | Cushion needle | 2 | 14 | Cushion packing | 2 |
| 3 | Piston | 2 | 9 | Cushion plug | 2 | 15 | Cylinder gasket | 2 |
| 4 | Piston rod | 1 | 10 | Oilless bearing | 1 | 16 | Piston gasket | 1 |
| 5 | Cylinder tube | 1 | 11 | Tie bolt | 8 | 17 | Dust cover | 2 |
| 6 | Magnet | 1 | 12 | Rod packing | 1 | 18 | Bumper | 2 |

How to order the seal kit

DNDSK

| Bore | Seal kit |
|------|--|
| 32 | DNDSK32 - Including No.10,11,12,13 |
| 40 | DNDSK40 - Including No.10,11,12,13,14 |
| 50 | DNDSK50 - Including No.10,11,12,13,14 |
| 63 | DNDSK63 - Including No.10,11,12,13,14 |
| 80 | DNDSK80 - Including No.10,11,12,13,14 |
| 100 | DNDSK100 - Including No.10,11,12,13,14 |

● Bore φ 32, φ 40

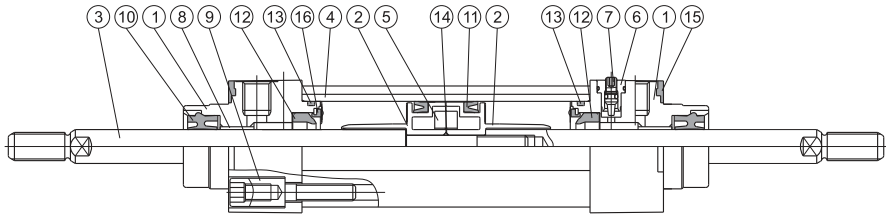

Parts List

| No. | part name | Quantity | No. | part name | Quantity | No. | part name | Quantity |
|-----|----------------|----------|-----|-----------------|----------|-----|-----------------|----------|
| 1 | Rod cover | 2 | 7 | Cushion plug | 2 | 13 | Cylinder gasket | 2 |
| 2 | Piston | 2 | 8 | Oilless bearing | 2 | 14 | Piston gasket | 1 |
| 3 | Piston rod | 1 | 9 | Tie bolt | 8 | 15 | Dust cover | 2 |
| 4 | Cylinder tube | 1 | 10 | Rod packing | 2 | 16 | Buffer pad | 2 |
| 5 | Magnet | 1 | 11 | Piston packing | 2 | | | |
| 6 | Cushion needle | 2 | 12 | Cushion packing | 2 | | | |

● Bore φ 50, φ 63, φ 80, φ 100

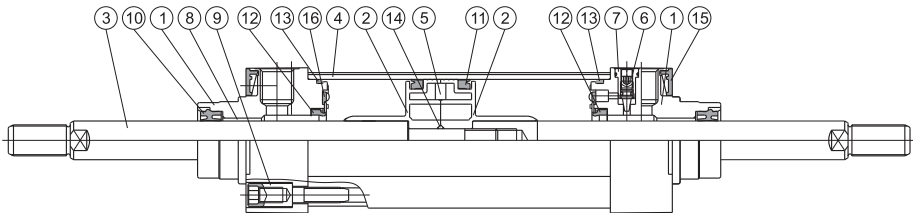

Parts List

| No. | part name | Quantity | No. | part name | Quantity | No. | part name | Quantity |
|-----|----------------|----------|-----|-----------------|----------|-----|-----------------|----------|
| 1 | Rod cover | 2 | 7 | Cushion plug | 2 | 13 | Cylinder gasket | 2 |
| 2 | Piston | 2 | 8 | Oilless bearing | 2 | 14 | Piston gasket | 1 |
| 3 | Piston rod | 2 | 9 | Tie bolt | 8 | 15 | Dust cover | 2 |
| 4 | Cylinder tube | 1 | 10 | Rod packing | 2 | 16 | Buffer pad | 2 |
| 5 | Magnet | 1 | 11 | Piston packing | 2 | | | |
| 6 | Cushion needle | 2 | 12 | Cushion packing | 2 | | | |

Dimensional features

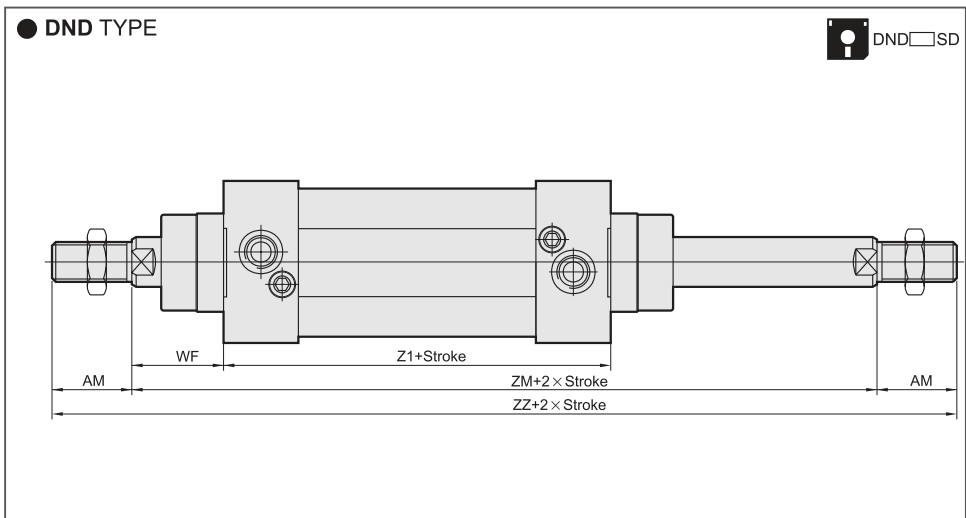
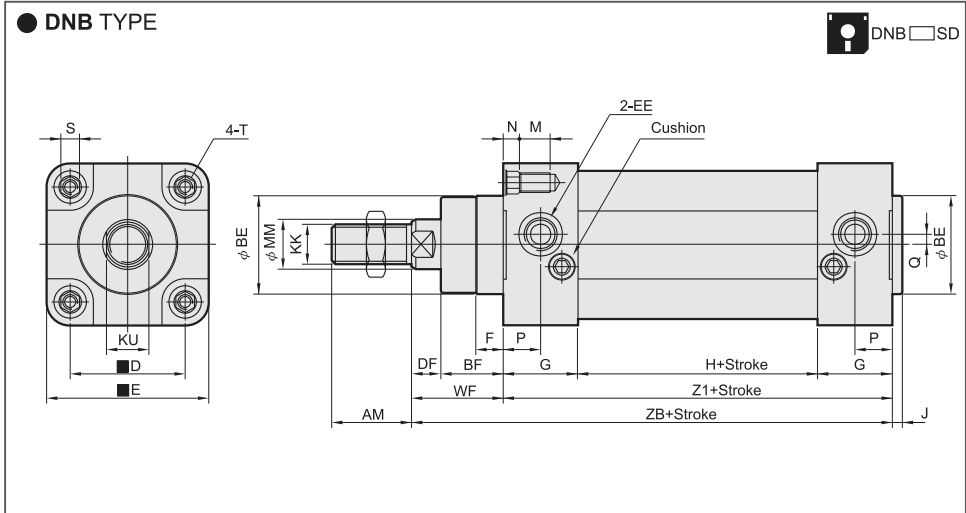

DA

DP

DS

DQ

DB

DN

BN

ST

NT

DU

DJ

TA

GP

GS

GM

GT

RT

CT

CH

Dimensional Table

| Bore | AM | BE | BF | D | DF | E | EE | F | G | H | J | KK | KU | M | MM | N | P | Q | S | T | WF | Z1 | ZB | ZM | ZZ |
|-------|----|----|----|------|----|-----|-------|----|----|----|---|----------|----|----|----|---|----|-----|----|-----|----|-----|-----|-----|-----|
| φ 32 | 22 | 30 | 16 | 32.5 | 10 | 47 | G 1/8 | 7 | 26 | 42 | 4 | M10×1.25 | 10 | 9 | 12 | 6 | 13 | 4.5 | 6 | M6 | 26 | 94 | 120 | 146 | 190 |
| φ 40 | 24 | 35 | 20 | 38 | 10 | 53 | G 1/4 | 9 | 30 | 45 | 4 | M12×1.25 | 14 | 9 | 16 | 6 | 15 | 5 | 6 | M6 | 30 | 105 | 135 | 165 | 213 |
| φ 50 | 32 | 40 | 25 | 46.5 | 12 | 65 | G 1/4 | 11 | 30 | 46 | 4 | M16×1.5 | 17 | 12 | 20 | 6 | 15 | 6 | 8 | M8 | 37 | 106 | 143 | 180 | 244 |
| φ 63 | 32 | 45 | 25 | 56.5 | 12 | 75 | G 3/8 | 4 | 32 | 57 | 4 | M16×1.5 | 17 | 12 | 20 | 6 | 16 | 8 | 8 | M8 | 37 | 121 | 158 | 195 | 259 |
| φ 80 | 40 | 45 | 33 | 72 | 13 | 95 | G 3/8 | 15 | 38 | 52 | 6 | M20×1.5 | 22 | 16 | 25 | 6 | 19 | 9 | 10 | M10 | 46 | 128 | 174 | 220 | 300 |
| φ 100 | 40 | 55 | 35 | 89 | 16 | 115 | G 1/2 | 15 | 40 | 58 | 6 | M20×1.5 | 22 | 16 | 25 | 6 | 20 | 7 | 10 | M10 | 51 | 138 | 189 | 240 | 320 |

Dimensional features

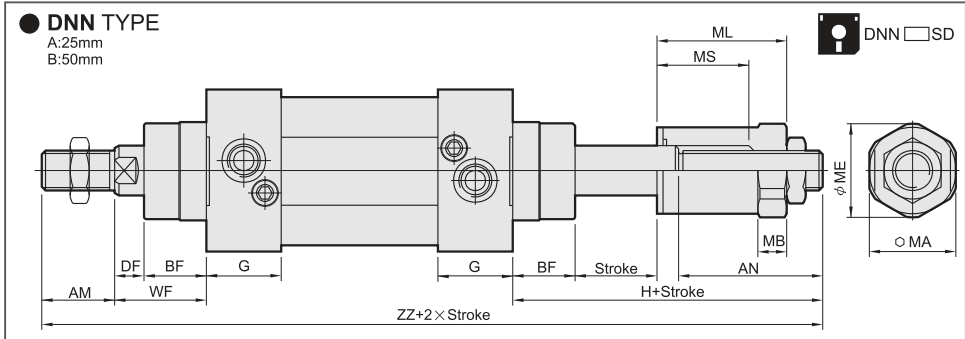

Dimensional Table

| Bore | AM | AN | | BF | DF | G | H | | MA | MB | ME | ML | | MS | | WF | ZZ | |
|-------|----|----|----|----|----|----|-----|-----|------|----|----|----|----|----|----|----|-----|-----|
| | | A | B | | | | A | B | | | | A | B | A | B | | | |
| φ 32 | 22 | 47 | 72 | 16 | 10 | 26 | 73 | 98 | 27 | 10 | 29 | 47 | 72 | 35 | 62 | 26 | 215 | 240 |
| φ 40 | 24 | 48 | 73 | 20 | 10 | 30 | 78 | 103 | 32 | 10 | 35 | 47 | 72 | 37 | 62 | 30 | 237 | 262 |
| φ 50 | 32 | 52 | 77 | 25 | 12 | 30 | 92 | 117 | 41 | 12 | 44 | 56 | 81 | 41 | 66 | 37 | 267 | 292 |
| φ 63 | 32 | 52 | 77 | 25 | 12 | 32 | 92 | 117 | 41 | 12 | 44 | 56 | 81 | 41 | 66 | 37 | 282 | 307 |
| φ 80 | 40 | 58 | 83 | 33 | 13 | 38 | 107 | 132 | 50.8 | 15 | 55 | 63 | 88 | 43 | 68 | 46 | 321 | 346 |
| φ 100 | 40 | 58 | 83 | 35 | 16 | 40 | 107 | 132 | 50.8 | 15 | 55 | 63 | 88 | 43 | 68 | 51 | 336 | 361 |

Accessories

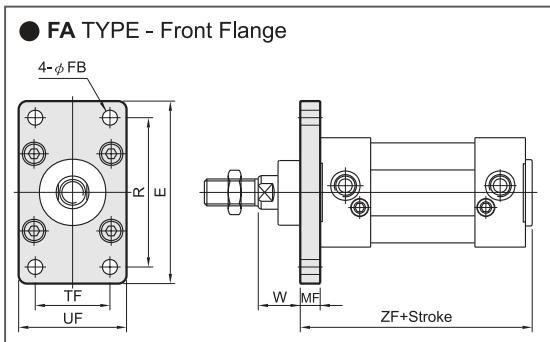

Dimensional Table

| Bore | E | FB | MF | R | TF | UF | W | ZF |
|-------|-----|----|----|-----|----|-----|----|-----|
| φ 32 | 79 | 7 | 10 | 64 | 32 | 50 | 16 | 108 |
| φ 40 | 90 | 9 | 10 | 72 | 36 | 55 | 20 | 120 |
| φ 50 | 110 | 9 | 12 | 90 | 45 | 65 | 25 | 123 |
| φ 63 | 120 | 9 | 12 | 100 | 50 | 75 | 25 | 138 |
| φ 80 | 153 | 12 | 16 | 126 | 63 | 95 | 30 | 150 |
| φ 100 | 178 | 14 | 16 | 150 | 75 | 115 | 35 | 160 |

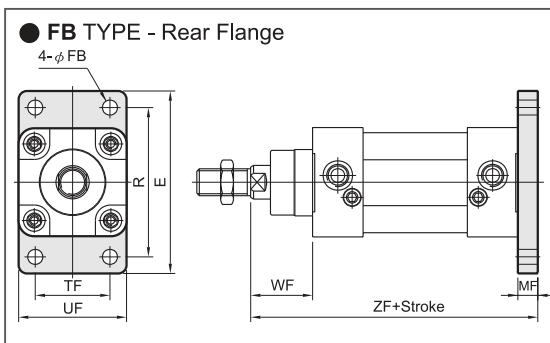

Dimensional Table

| Bore | E | FB | MF | R | TF | UF | WF | ZF |
|-------|-----|----|----|-----|----|-----|----|-----|
| φ 32 | 79 | 7 | 10 | 64 | 32 | 50 | 26 | 130 |
| φ 40 | 90 | 9 | 10 | 72 | 36 | 55 | 30 | 145 |
| φ 50 | 110 | 9 | 12 | 90 | 45 | 65 | 37 | 155 |
| φ 63 | 120 | 9 | 12 | 100 | 50 | 75 | 37 | 170 |
| φ 80 | 153 | 12 | 16 | 126 | 63 | 95 | 46 | 190 |
| φ 100 | 178 | 14 | 16 | 150 | 75 | 115 | 51 | 205 |

Accessories

● TC TYPE - Intermediate Pivot

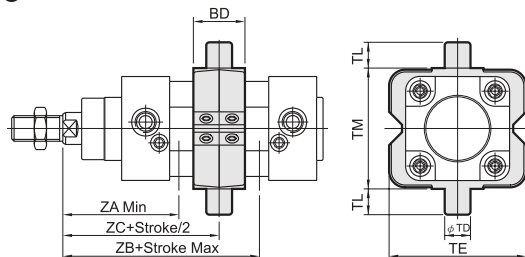

Dimensional Table



DN □ TC

| Bore | BD | TD | TE | TL | TM | ZA | ZB | ZC |
|-------|----|----|-----|----|-----|-------|-------|------|
| φ 32 | 22 | 12 | 58 | 12 | 50 | 63 | 83 | 73 |
| φ 40 | 28 | 16 | 70 | 16 | 63 | 74 | 91 | 82.5 |
| φ 50 | 32 | 16 | 85 | 16 | 75 | 83 | 97 | 90 |
| φ 63 | 35 | 20 | 100 | 20 | 90 | 86.5 | 108.5 | 97.5 |
| φ 80 | 40 | 20 | 120 | 20 | 110 | 104 | 116 | 110 |
| φ 100 | 45 | 25 | 145 | 25 | 132 | 113.5 | 126.5 | 120 |

● CA TYPE - Male Pivot

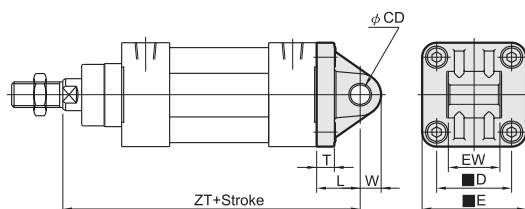

Dimensional Table



DN □ CA

| Bore | CD | D | E | EW | L | T | W | ZT |
|-------|----|------|-----|----|----|----|------|-----|
| φ 32 | 10 | 32.5 | 47 | 26 | 22 | 10 | 10.5 | 142 |
| φ 40 | 12 | 38 | 53 | 28 | 25 | 10 | 13 | 160 |
| φ 50 | 12 | 46.5 | 65 | 32 | 27 | 11 | 13 | 170 |
| φ 63 | 16 | 56.5 | 75 | 40 | 32 | 11 | 17 | 190 |
| φ 80 | 16 | 72 | 95 | 50 | 36 | 15 | 17 | 210 |
| φ 100 | 20 | 89 | 115 | 60 | 41 | 15 | 21 | 230 |

● CB TYPE - Female Pivot

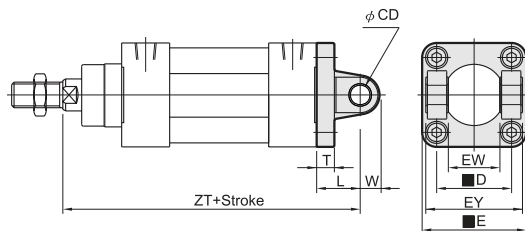

Dimensional Table



DN □ CB

| Bore | CD | D | E | EW | EY | L | T | W | ZT |
|-------|----|------|-----|----|-----|----|----|------|-----|
| φ 32 | 10 | 32.5 | 47 | 26 | 45 | 22 | 10 | 10.5 | 142 |
| φ 40 | 12 | 38 | 53 | 28 | 52 | 25 | 10 | 11 | 160 |
| φ 50 | 12 | 46.5 | 65 | 32 | 60 | 27 | 11 | 12 | 170 |
| φ 63 | 16 | 56.5 | 75 | 40 | 70 | 32 | 11 | 15 | 190 |
| φ 80 | 16 | 72 | 95 | 50 | 90 | 36 | 15 | 17 | 210 |
| φ 100 | 20 | 89 | 115 | 60 | 110 | 41 | 15 | 21 | 230 |

● LB TYPE - Foot Mounting

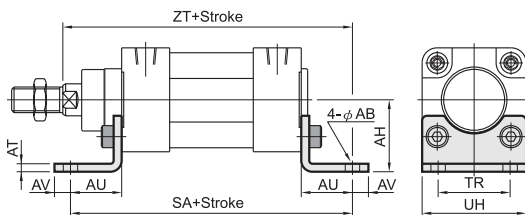

Dimensional Table



DN □ LB

| Bore | AB | AH | AT | AU | AV | SA | TR | UH | ZT |
|-------|----|----|----|----|----|-----|----|-----|-----|
| φ 32 | 7 | 32 | 5 | 24 | 8 | 142 | 32 | 47 | 144 |
| φ 40 | 9 | 36 | 5 | 28 | 10 | 161 | 36 | 53 | 163 |
| φ 50 | 9 | 45 | 5 | 32 | 10 | 170 | 45 | 65 | 175 |
| φ 63 | 9 | 50 | 5 | 32 | 10 | 185 | 50 | 75 | 190 |
| φ 80 | 12 | 63 | 6 | 41 | 13 | 210 | 63 | 95 | 215 |
| φ 100 | 14 | 71 | 6 | 41 | 15 | 220 | 75 | 115 | 230 |

DA

DP

DS

DQ

DB

DN

BN

ST

NT

DU

DJ

TA

GP

GS

GM

GT

RT

CT

CH

Accessories

● CG TYPE - Male Pivot

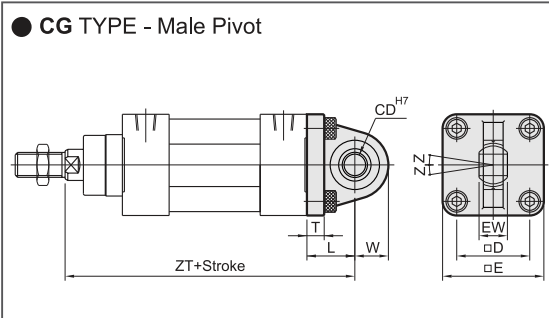

Dimensional Table



DN □ CG

| Bore | CD | D | E | EW | L | T | W | Z | ZT |
|-------|----|------|-----|----|----|----|----|-----|-----|
| φ 32 | 10 | 32.5 | 47 | 14 | 22 | 10 | 17 | 13° | 142 |
| φ 40 | 12 | 38 | 53 | 16 | 25 | 10 | 20 | 13° | 160 |
| φ 50 | 12 | 46.5 | 65 | 16 | 27 | 11 | 22 | 13° | 170 |
| φ 63 | 16 | 56.5 | 75 | 21 | 32 | 11 | 26 | 15° | 190 |
| φ 80 | 16 | 72 | 95 | 21 | 36 | 15 | 28 | 15° | 210 |
| φ 100 | 20 | 89 | 115 | 25 | 41 | 15 | 32 | 15° | 230 |

● CD TYPE

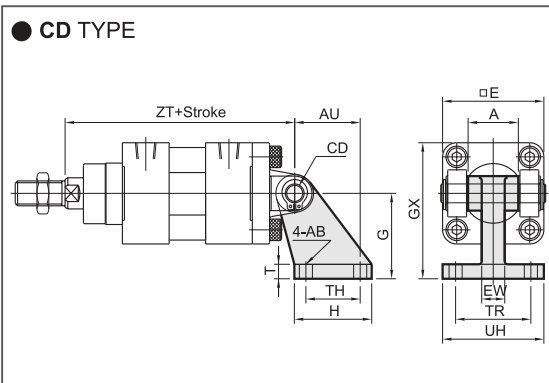

Dimensional Table



DN □ CD

| Bore | A | AB | AU | CD | E | EW | T | G | GX |
|-------|----|----|----|----|-----|----|----|----|-------|
| φ 32 | 26 | 7 | 21 | 10 | 47 | 10 | 8 | 32 | 55.5 |
| φ 40 | 28 | 7 | 24 | 12 | 53 | 12 | 10 | 36 | 62.5 |
| φ 50 | 32 | 9 | 33 | 12 | 65 | 12 | 12 | 45 | 77.5 |
| φ 63 | 40 | 9 | 37 | 16 | 75 | 15 | 12 | 50 | 87.5 |
| φ 80 | 50 | 11 | 47 | 16 | 95 | 15 | 14 | 63 | 110.5 |
| φ 100 | 60 | 11 | 55 | 20 | 115 | 22 | 15 | 71 | 128.5 |

| Bore | H | TH | TR | UH | ZT |
|-------|----|----|----|----|-----|
| φ 32 | 31 | 18 | 38 | 51 | 142 |
| φ 40 | 35 | 22 | 41 | 54 | 160 |
| φ 50 | 45 | 30 | 50 | 65 | 170 |
| φ 63 | 50 | 35 | 52 | 67 | 190 |
| φ 80 | 60 | 40 | 66 | 86 | 210 |
| φ 100 | 70 | 50 | 76 | 96 | 230 |

● CB Pin Type

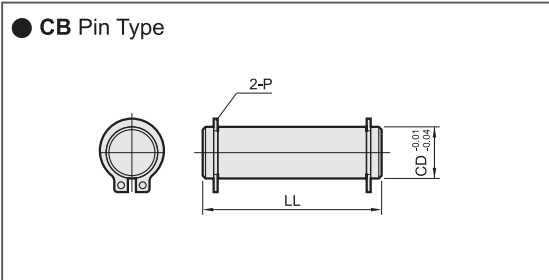

Dimensional Table



DN □ PIN

| Bore | CD | LL | P |
|-------|----|-----|--------|
| φ 32 | 10 | 53 | STW-10 |
| φ 40 | 12 | 62 | STW-12 |
| φ 50 | 12 | 69 | STW-12 |
| φ 63 | 16 | 80 | STW-16 |
| φ 80 | 16 | 100 | STW-16 |
| φ 100 | 20 | 122 | STW-20 |

Accessories

● Y Rod Clevis (With Pin)

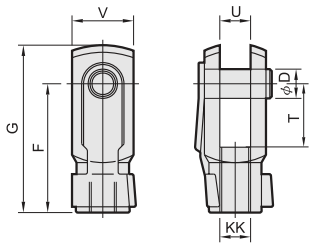

Dimensional Table

| Type | Bore | D | F | G | KK | T | U | V |
|--------------|-------------|----|----|-----|------------|----|----|----|
| Y-M10 × 1.25 | φ 32 | 10 | 40 | 52 | M10 × 1.25 | 20 | 10 | 20 |
| Y-M12 × 1.25 | φ 40 | 12 | 48 | 62 | M12 × 1.25 | 24 | 12 | 24 |
| Y-M16 × 1.5 | φ 50, φ 63 | 16 | 64 | 83 | M16 × 1.5 | 32 | 16 | 32 |
| Y-M20 × 1.5 | φ 80, φ 100 | 20 | 80 | 105 | M20 × 1.5 | 40 | 20 | 40 |



| Type | Filename |
|--------------|----------|
| Y-M10 × 1.25 | YM10125 |
| Y-M12 × 1.25 | YM12125 |
| Y-M16 × 1.5 | YM16150 |
| Y-M20 × 1.5 | YM20150 |

● Oscillating Eye

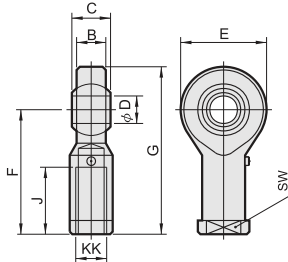

Dimensional Table

| Type | Bore | B | C | D | E | F | G | J | KK | SW |
|--------------|-------------|------|----|----|----|----|-----|----|------------|----|
| G-M10 × 1.25 | φ 32 | 10.5 | 14 | 10 | 28 | 43 | 57 | 20 | M10 × 1.25 | 17 |
| G-M12 × 1.25 | φ 40 | 12 | 16 | 12 | 30 | 50 | 65 | 24 | M12 × 1.25 | 19 |
| G-M16 × 1.5 | φ 50, φ 63 | 15 | 21 | 16 | 38 | 64 | 83 | 33 | M16 × 1.5 | 22 |
| G-M20 × 1.5 | φ 80, φ 100 | 18 | 25 | 20 | 46 | 77 | 100 | 40 | M20 × 1.5 | 30 |



| Type | Filename |
|--------------|----------|
| G-M10 × 1.25 | GM10125 |
| G-M12 × 1.25 | GM12125 |
| G-M16 × 1.5 | GM16150 |
| G-M20 × 1.5 | GM20150 |

● Compensating Joint

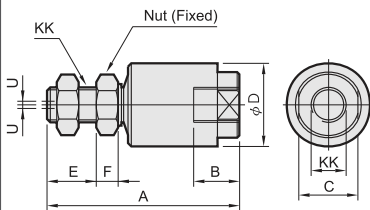

Dimensional Table

| Type | Bore | A | B | C | D | E | F | KK | U |
|--------------|-------------|-----|----|----|------|------|----|------------|------|
| K-M10 × 1.25 | φ 32 | 54 | 13 | 24 | 25.5 | 14.5 | 6 | M10 × 1.25 | 1 |
| K-M12 × 1.25 | φ 40 | 70 | 17 | 29 | 31 | 19 | 7 | M12 × 1.25 | 1.15 |
| K-M16 × 1.5 | φ 50, φ 63 | 88 | 21 | 27 | 38 | 29 | 8 | M16 × 1.5 | 1.65 |
| K-M20 × 1.5 | φ 80, φ 100 | 105 | 25 | 32 | 50 | 27.5 | 16 | M20 × 1.5 | 2.15 |



| Type | Filename |
|--------------|----------|
| K-M10 × 1.25 | KM10125 |
| K-M12 × 1.25 | KM12125 |
| K-M16 × 1.5 | KM16150 |
| K-M20 × 1.5 | KM20150 |

● Mounting Nut

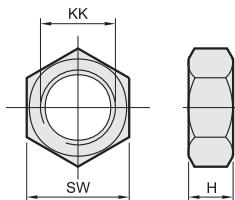

Dimensional Table

| Type | Bore | H | KK | SW |
|--------------|-------------|---|------------|----|
| N-M10 × 1.25 | φ 32 | 6 | M10 × 1.25 | 17 |
| N-M12 × 1.25 | φ 40 | 7 | M12 × 1.25 | 19 |
| N-M16 × 1.5 | φ 50, φ 63 | 8 | M16 × 1.5 | 24 |
| N-M20 × 1.5 | φ 80, φ 100 | 8 | M20 × 1.5 | 27 |



| Type | Filename |
|--------------|----------|
| N-M10 × 1.25 | NM10125 |
| N-M12 × 1.25 | NM12125 |
| N-M16 × 1.5 | NM16150 |
| N-M20 × 1.5 | NM20150 |

DA

DP

DS

DQ

DB

DN

BN

ST

NT

DU

DJ

TA

GP

GS

GM

GT

RT

CT

CH

Installation of sensor switches

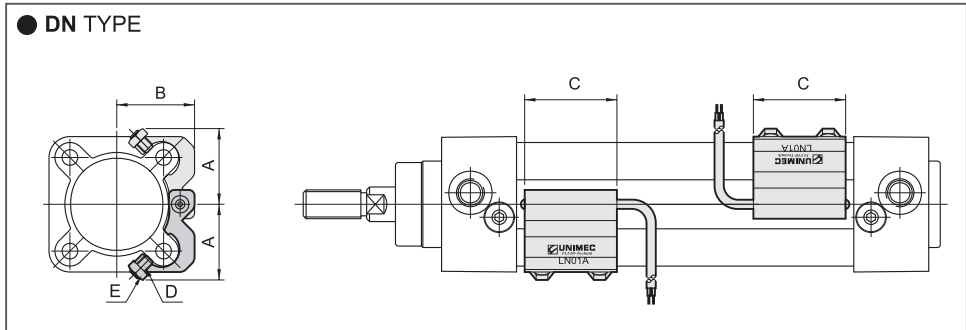

Dimensional Table

| Bore | Sensor switch | A | B | C | D | E |
|-------|---------------|------|------|----|----------|----|
| φ 32 | LN01A | 26.3 | 27 | 32 | M4 × 12L | M4 |
| φ 40 | LN01A | 29 | 32 | 32 | M4 × 12L | M4 |
| φ 50 | LN02A | 35.5 | 36.5 | 32 | M4 × 12L | M4 |
| φ 63 | LN02A | 40 | 43 | 32 | M4 × 12L | M4 |
| φ 80 | LN03A | 49.5 | 52 | 32 | M4 × 12L | M4 |
| φ 100 | LN03A | 57.5 | 62 | 32 | M4 × 12L | M4 |

Cylinder Weight (Including The Mounting Nut)

Unit: kg

| Bore | Basic weight DNB | Stroke 25 mm DNB | Basic weight DND | Stroke 25 mm DND | Basic weight DNN | Stroke 25 mm DNN | Basic weight DNN | Stroke 25 mm DNN |
|-------|------------------|------------------|------------------|------------------|-------------------------|------------------|-------------------------|------------------|
| | | | | | | | | |
| | | | | | Adjustable Stroke 25 mm | | Adjustable Stroke 50 mm | |
| φ 32 | 0.56 | 0.056 | 0.62 | 0.078 | 0.78 | 0.078 | 0.86 | 0.078 |
| φ 40 | 0.85 | 0.080 | 0.98 | 0.120 | 1.09 | 0.120 | 1.22 | 0.120 |
| φ 50 | 1.22 | 0.117 | 1.46 | 0.179 | 1.82 | 0.179 | 2.07 | 0.179 |
| φ 63 | 1.72 | 0.128 | 1.96 | 0.189 | 2.26 | 0.189 | 2.51 | 0.189 |
| φ 80 | 3.25 | 0.188 | 3.69 | 0.285 | 4.45 | 0.285 | 4.79 | 0.285 |
| φ 100 | 4.28 | 0.220 | 4.87 | 0.317 | 5.63 | 0.317 | 5.97 | 0.317 |

Mounting Weight (Including The Mounting Screws)

Unit: kg

| Bore | FA FB | CA | CB | LB | TC | CD | CG | CB-Pin | Y |
|-------|-------|-------|-------|-------|-------|-------|-------|--------|-------|
| | | | | | | | | | |
| φ 32 | 0.224 | 0.225 | 0.197 | 0.170 | 0.104 | 0.175 | 0.179 | 0.032 | 0.088 |
| φ 40 | 0.266 | 0.306 | 0.221 | 0.219 | 0.210 | 0.223 | 0.242 | 0.053 | 0.147 |
| φ 50 | 0.480 | 0.473 | 0.420 | 0.344 | 0.328 | 0.383 | 0.387 | 0.061 | 0.335 |
| φ 63 | 0.602 | 0.743 | 0.600 | 0.405 | 0.492 | 0.538 | 0.583 | 0.124 | 0.335 |
| φ 80 | 1.424 | 1.366 | 1.134 | 0.839 | 0.740 | 0.906 | 1.047 | 0.156 | 0.677 |
| φ 100 | 1.974 | 2.156 | 1.795 | 1.045 | 1.223 | 1.370 | 1.531 | 0.298 | 0.677 |

| Bore | G | Nut(Rod) | Sensor switch |
|-------|-------|----------|---------------|
| | | | |
| φ 32 | 0.080 | 0.008 | 0.065 |
| φ 40 | 0.112 | 0.010 | 0.065 |
| φ 50 | 0.202 | 0.017 | 0.066 |
| φ 63 | 0.202 | 0.017 | 0.066 |
| φ 80 | 0.368 | 0.020 | 0.086 |
| φ 100 | 0.368 | 0.020 | 0.086 |

Multiple Position Cylinders

DNE

Double Acting - Back To Back Standard Type



DNZ

Double Acting - Face To Face Standard Type



DNE..M

Double Acting - Back To Back With Magnetic Piston Type



DNZ..M

Double Acting - Face To Face With Magnetic Piston Type

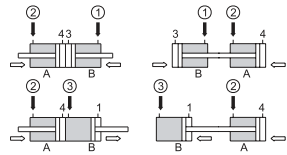

① ② Air intake, cylinders A & B retract.

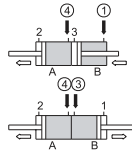

① ④ Air intake, cylinder A extends, cylinder B retracts.
④ ③ Air intake, cylinders A & B extend.

Specification

| | | | | | | |
|-------------------------------|--|------|------|------|------|-------|
| Bore sizes of cylinder (mm) | φ 32 | φ 40 | φ 50 | φ 63 | φ 80 | φ 100 |
| Standard stroke (mm) | Stroke by request | | | | | |
| The range of stroke (mm) | Max. 300 | | | | | |
| Power fluid | Filtered air with or without lubrication | | | | | |
| Material of cylinder barrel | Aluminium extrusion, Anodised 20 microns | | | | | |
| The range of pressure (MPa) | 0.1~1.03 | | | | | |
| The range of temperature (°C) | -10~+60 | | | | | |

How to order

| | | | | | | | |
|------------|--|--------------------------------|--------------------|-----------------------|------------|---|-------------------|
| DNE | 32 | M | 50 / 100 | FA - Y - LN01A | × 2 | | |
| Type | Bore | Magnet | A Stroke | B Stroke | Accessory | Sensor switch | Quantity |
| | 32-φ 32mm 40-φ 40mm 50-φ 50mm 63-φ 63mm 80-φ 80mm 100-φ 100mm | M: With magnet N: No magnet | Strokes by request | Strokes by request | | | 1: 1pc 2: 2pcs |
| | | | | | | <p>Note:</p> <p>LN01A: Suited for φ 32, φ 40 LN02A: Suited for φ 50, φ 63 LN03A: Suited for φ 80, φ 100</p> <p>1.Can choose NPN or PNP type (3-Wire type, 24VDC). 2.Can choose plug-in cable. 3.For details see page 4-1.1.</p> | |
| | | | | | | | |

- DA
- DP
- DS
- DQ
- DB
- DN
- BN
- ST
- NT
- DU
- DJ
- TA
- GP
- GS
- GM
- GT
- RT
- CT
- CH

Dimensional features

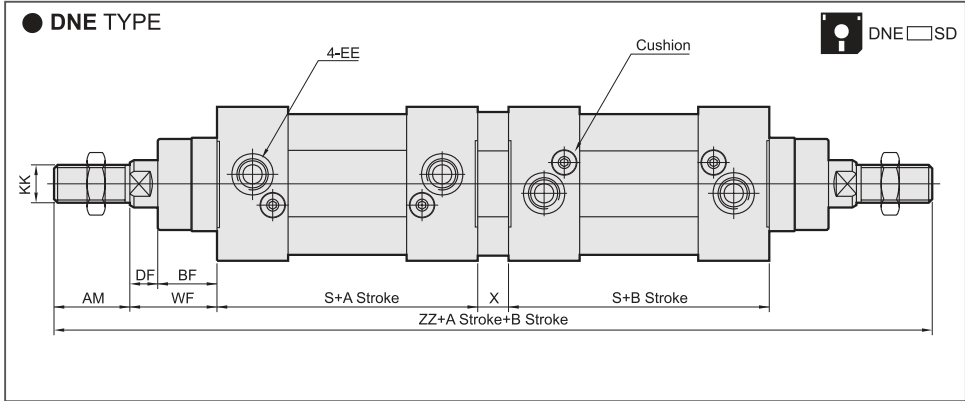

Dimensional Table

| Bore | AM | BF | DF | EE | KK | S | WF | X | ZZ |
|-------|----|----|----|-------|------------|-----|----|----|-----|
| φ 32 | 22 | 16 | 10 | G 1/8 | M10 × 1.25 | 94 | 26 | 10 | 294 |
| φ 40 | 24 | 20 | 10 | G 1/4 | M12 × 1.25 | 105 | 30 | 10 | 328 |
| φ 50 | 32 | 25 | 12 | G 1/4 | M16 × 1.5 | 106 | 37 | 12 | 362 |
| φ 63 | 32 | 25 | 12 | G 3/8 | M16 × 1.5 | 121 | 37 | 12 | 392 |
| φ 80 | 40 | 33 | 13 | G 3/8 | M20 × 1.5 | 128 | 46 | 16 | 444 |
| φ 100 | 40 | 35 | 16 | G 1/2 | M20 × 1.5 | 138 | 51 | 16 | 474 |

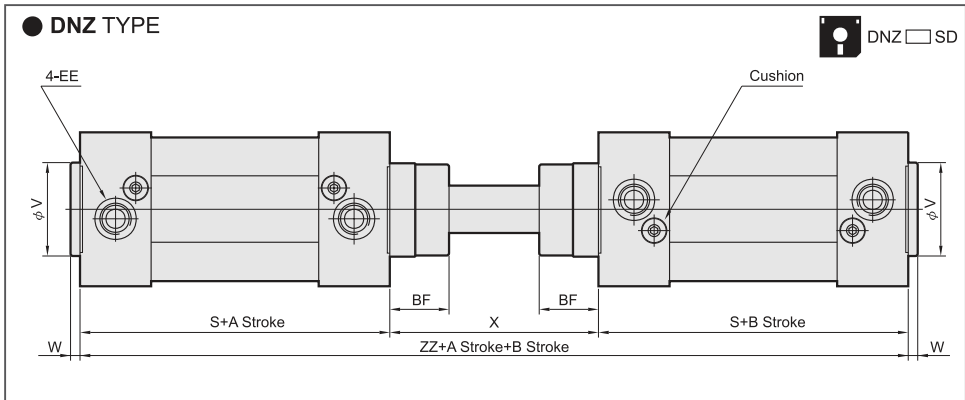

Dimensional Table

| Bore | BF | EE | S | V | W | X | ZZ |
|-------|----|-------|-----|----|---|----|-----|
| φ 32 | 16 | G 1/8 | 94 | 30 | 4 | 55 | 243 |
| φ 40 | 20 | G 1/4 | 105 | 35 | 5 | 55 | 265 |
| φ 50 | 25 | G 1/4 | 106 | 40 | 5 | 68 | 280 |
| φ 63 | 25 | G 3/8 | 121 | 45 | 5 | 68 | 310 |
| φ 80 | 33 | G 3/8 | 128 | 45 | 6 | 92 | 348 |
| φ 100 | 35 | G 1/2 | 138 | 55 | 6 | 92 | 368 |

Tandem Cylinders & Multiple Position Cylinders

DNF

Multiple Position Cylinders - Standard Type

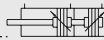

DNF..M

Multiple Position Cylinders - With Magnetic Piston Type



DNL

Tandem Cylinders - Standard Type

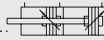

DNL..M

Tandem Cylinders - With Magnetic Piston Type

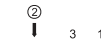
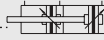

② Air intake, cylinders A&B

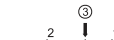

③ Air intake, cylinder B

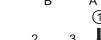

① Air intake, cylinder A extends.

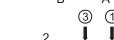

①③ Simultaneous air intake with double output force.

Specification

| | | | | | | |
|-------------------------------|--|------|------|------|------|-------|
| Bore sizes of cylinder (mm) | φ 32 | φ 40 | φ 50 | φ 63 | φ 80 | φ 100 |
| Standard stroke (mm) | Stroke by request | | | | | |
| The range of stroke (mm) | Max. 500 | | | | | |
| Power fluid | Filtered air with or without lubrication | | | | | |
| Material of cylinder barrel | Aluminium extrusion, Anodised 20 microns | | | | | |
| The range of pressure (MPa) | 0.1~1.03 | | | | | |
| The range of temperature (°C) | -10~+60 | | | | | |

How to order

| | | | | | | | |
|------------|--|--------------------------------|--------------------|-----------------------|-----------|--|-------------------|
| DNF | 32 | N | 50 / 100 | FA - Y - LN01A | × | 2 | |
| Type | Bore | Magnet | First Stroke | Second Stroke | Accessory | Sensor switch | Quantity |
| | 32—φ 32mm 40—φ 40mm 50—φ 50mm 63—φ 63mm 80—φ 80mm 100—φ 100mm | M: With magnet N: No magnet | Strokes by request | Strokes by request | | | 1: 1pc 2: 2pcs |
| | | | | | | <p>LN01A: Suited for φ 32, φ 40 LN02A: Suited for φ 50, φ 63 LN03A: Suited for φ 80, φ 100</p> <p>Note: 1.Can choose NPN or PNP type (3-Wire type, 24VDC). 2.Can choose plug-in cable. 3.For details see page 4-1.1.</p> | |
| | | | | | | | |

- DA
- DP
- DS
- DQ
- DB
- DN
- BN
- ST
- NT
- DU
- DJ
- TA
- GP
- GS
- GM
- GT
- RT
- CT
- CH

Dimensional features

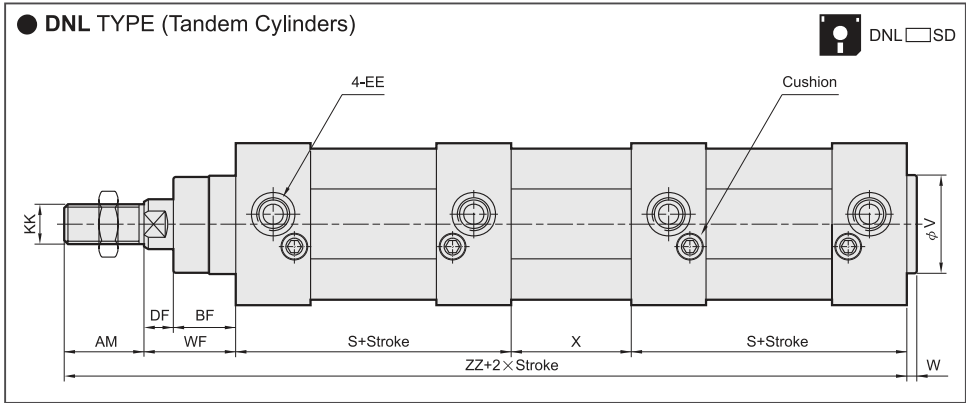

Dimensional Table

| Bore | AM | BF | DF | EE | KK | S | V | W | WF | X | ZZ |
|-------|----|----|----|-------|------------|-----|----|---|----|----|-----|
| φ 32 | 22 | 16 | 10 | G 1/8 | M10 × 1.25 | 94 | 30 | 4 | 26 | 55 | 291 |
| φ 40 | 24 | 20 | 10 | G 1/4 | M12 × 1.25 | 105 | 35 | 5 | 30 | 55 | 319 |
| φ 50 | 32 | 25 | 12 | G 1/4 | M16 × 1.5 | 106 | 40 | 5 | 37 | 68 | 349 |
| φ 63 | 32 | 25 | 12 | G 3/8 | M16 × 1.5 | 121 | 45 | 5 | 37 | 68 | 379 |
| φ 80 | 40 | 33 | 13 | G 3/8 | M20 × 1.5 | 128 | 45 | 6 | 46 | 92 | 434 |
| φ 100 | 40 | 35 | 16 | G 1/2 | M20 × 1.5 | 138 | 55 | 6 | 51 | 92 | 459 |

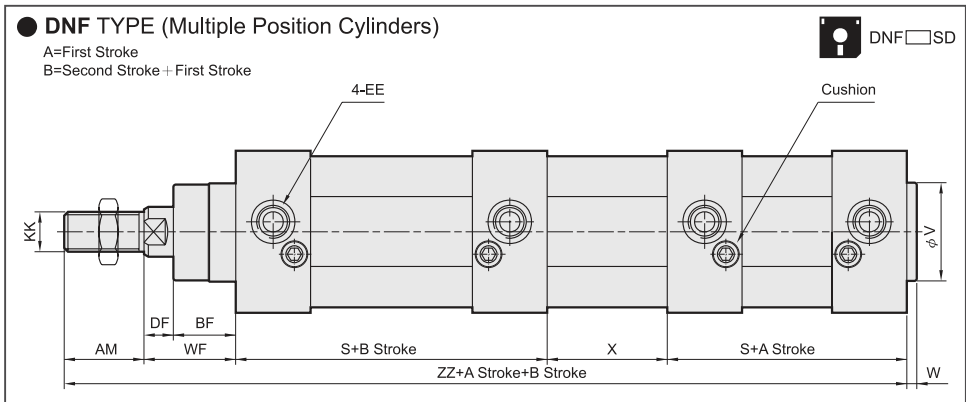

Dimensional Table

| Bore | AM | BF | DF | EE | KK | S | V | W | WF | X | ZZ |
|-------|----|----|----|-------|------------|-----|----|---|----|----|-----|
| φ 32 | 22 | 16 | 10 | G 1/8 | M10 × 1.25 | 94 | 30 | 4 | 26 | 55 | 291 |
| φ 40 | 24 | 20 | 10 | G 1/4 | M12 × 1.25 | 105 | 35 | 5 | 30 | 55 | 319 |
| φ 50 | 32 | 25 | 12 | G 1/4 | M16 × 1.5 | 106 | 40 | 5 | 37 | 68 | 349 |
| φ 63 | 32 | 25 | 12 | G 3/8 | M16 × 1.5 | 121 | 45 | 5 | 37 | 68 | 379 |
| φ 80 | 40 | 33 | 13 | G 3/8 | M20 × 1.5 | 128 | 45 | 6 | 46 | 92 | 434 |
| φ 100 | 40 | 35 | 16 | G 1/2 | M20 × 1.5 | 138 | 55 | 6 | 51 | 92 | 459 |

Double acting cylinders

| | | |
|-----------------------------|--|----------------------|
| DNB | Double Acting - Single End Rod Type | |
| DNB..M | Double Acting - Single End Rod Type (piston with magnet) | |
| DND | Double Acting - Double End Rod Type | |
| DND..M | Double Acting - Double End Rod Type (piston with magnet) | |
| DNN..N..A, DNN..N..B | Adjustable Forward Stroke Cylinder | A:25mm B:50mm |
| DNN..M..A, DNN..M..B | Adjustable Forward Stroke Cylinder (piston with magnet) | A:25mm B:50mm |



● DN Series cylinders according to ISO 6431 (Bore sizes φ 125 ~ φ 160)

DA

DP

DS

DQ

DB

DN

BN

ST

NT

DU

DJ

TA

GP

GS

GM

GT

RT

CT

CH

Specification

| | | |
|-------------------------------|--|-------|
| Bore sizes of cylinder (mm) | φ 125 | φ 160 |
| Standard stroke (mm) | 25,50,75,100,125,150,175,200,250,300,350,400,450,500 | |
| The range of stroke (mm) | Stroke till 1500mm by request | |
| Power fluid | Filtered air with or without lubrication | |
| Material of cylinder barrel | Aluminium extrusion, Anodised 20 microns | |
| The range of pressure (MPa) | 0.1~1.03 | |
| The range of temperature (°C) | -10~+60 | |

How to order

DNN 125 N 125 B FA - Y - LN02A × 2

| Type | Bore | Magnet | Stroke | Adjustable stroke | Accessory | Sensor switch | Quantity |
|---------------------|----------------------------|--------------------------------|--|--|---|--|-------------------|
| DNB | 125—φ 125mm 160—φ 160mm | M: With magnet N: No magnet | 25—25mm 50—50mm 75—75mm 100—100mm 125—125mm 150—150mm 175—175mm 200—200mm 250—250mm 300—300mm 350—350mm 400—400mm 450—450mm 500—500mm | None: standard A: Adjustable 25mm B: Adjustable 50mm Note: this number can only be used for the adjustable type. | FA FB TC CA CB LB Y | LN02A LN02A: Suited for DN φ 125 LN03A: Suited for DN φ 160 Note: 1.Can choose NPN or PNP type (3-Wire type, 24VDC). 2.Can choose plug-in cable. 3.For details see page 4-1.1. | 1: 1pc 2: 2pcs |
| Suited for DN φ 125 | | | | | | | |
| CG | G | CD | K | | | | |

Dimensional features

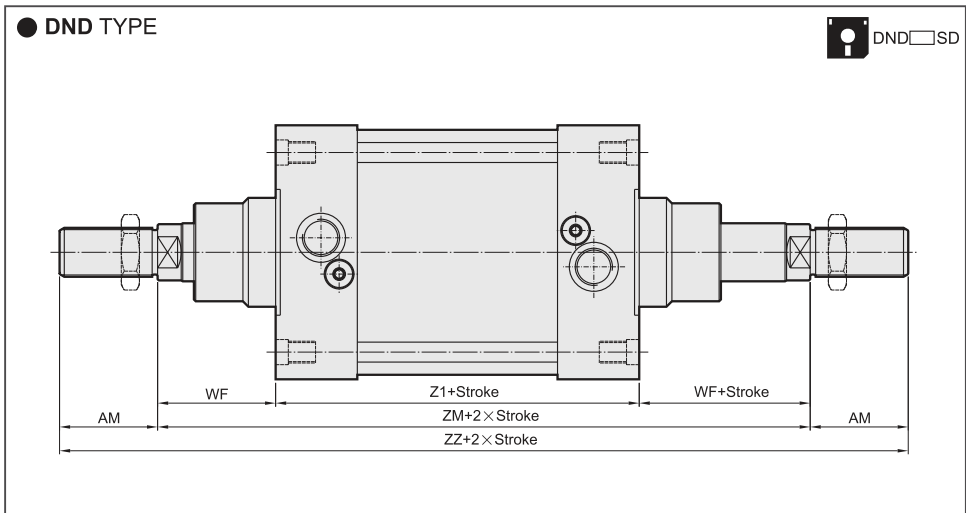
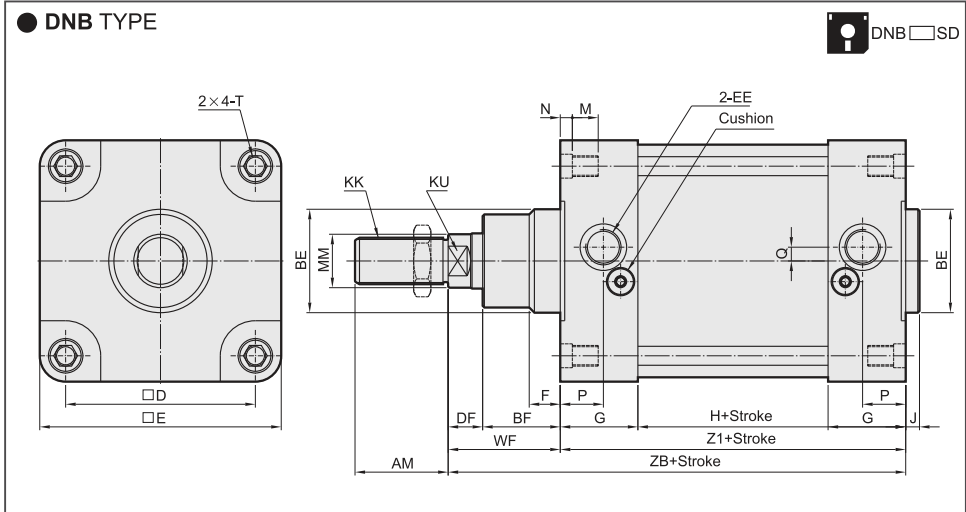

Dimensional Table

| Bore | AM | BE | BF | D | DF | E | EE | F | G | H | J | KK | KU | M | MM | N | P | Q | T | WF | Z1 | ZB | ZM | ZZ |
|-------|----|----|----|-----|----|-----|-------|----|----|----|---|-----------|----|----|----|---|------|---|-----|----|-----|-----|-----|-----|
| φ 125 | 54 | 60 | 45 | 110 | 20 | 140 | G 1/2 | 18 | 45 | 70 | 8 | M27 × 2.0 | 27 | 15 | 32 | 5 | 22.5 | 8 | M12 | 65 | 160 | 225 | 290 | 398 |

Dimensional features

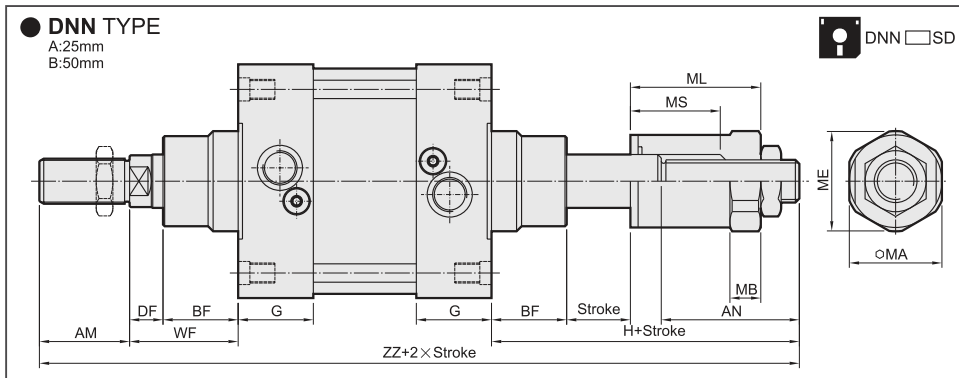

Dimensional Table

| Bore | AM | AN | | BF | DF | G | H | | MA | MB | ME | ML | | MS | | WF | ZZ | |
|-------|----|----|----|----|----|----|-----|-----|----|----|----|----|----|----|----|----|-----|-----|
| | | A | B | | | | A | B | | | | A | B | A | B | | | |
| φ 125 | 54 | 63 | 88 | 45 | 20 | 45 | 128 | 153 | 57 | 18 | 64 | 65 | 90 | 47 | 72 | 65 | 407 | 432 |

Accessories

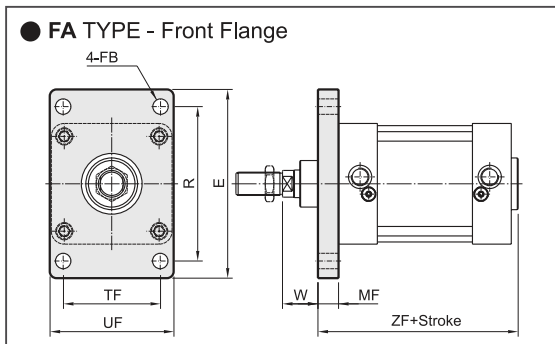

Dimensional Table

| Bore | E | FB | MF | R | TF | UF | W | ZF |
|-------|-----|----|----|-----|----|-----|----|-----|
| φ 125 | 220 | 16 | 20 | 180 | 90 | 140 | 45 | 188 |

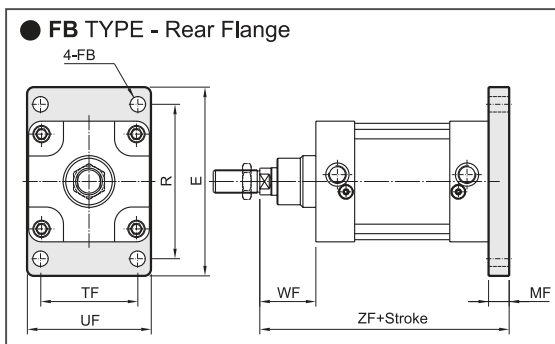

Dimensional Table

| Bore | E | FB | MF | R | TF | UF | WF | ZF |
|-------|-----|----|----|-----|----|-----|----|-----|
| φ 125 | 220 | 16 | 20 | 180 | 90 | 140 | 65 | 245 |

DA

DP

DS

DQ

DB

DN

BN

ST

NT

DU

DJ

TA

GP

GS

GM

GT

RT

CT

CH

Accessories

● TC TYPE - Intermediate Pivot

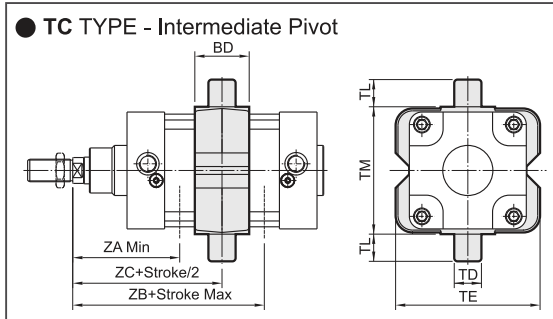

Dimensional Table



DN □ TC

| Bore | BD | TD | TE | TL | TM | ZA | ZB | ZC |
|-------|----|----|-----|----|-----|-----|-----|-----|
| φ 125 | 40 | 25 | 157 | 25 | 160 | 135 | 155 | 145 |

● CA TYPE - Male Pivot

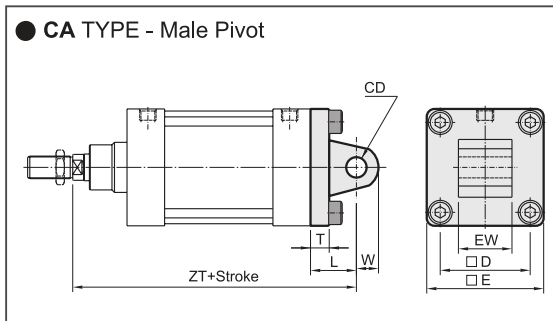

Dimensional Table



DN □ CA

| Bore | CD | D | E | EW | L | T | W | ZT |
|-------|----|-----|-----|----|----|----|----|-----|
| φ 125 | 25 | 110 | 140 | 70 | 50 | 17 | 26 | 275 |

● CB TYPE - Female Pivot

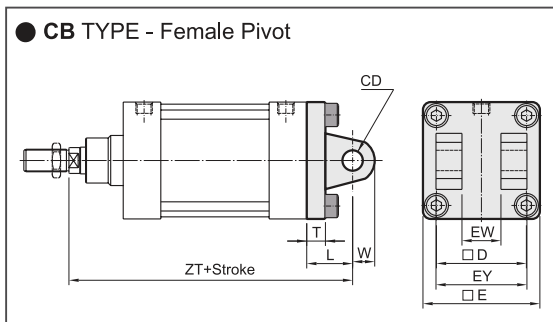

Dimensional Table



DN □ CB

| Bore | CD | D | E | EW | EY | L | T | W | ZT |
|-------|----|-----|-----|----|-----|----|----|----|-----|
| φ 125 | 25 | 110 | 140 | 70 | 130 | 50 | 17 | 26 | 275 |

● LB TYPE - Foot Mounting

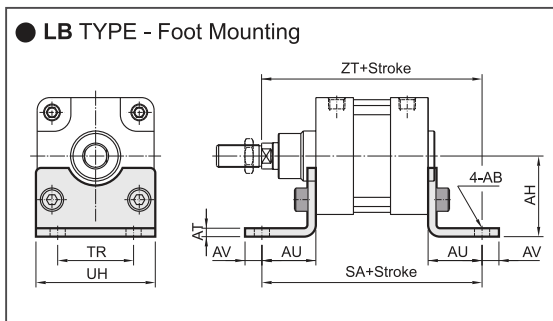

Dimensional Table



DN □ LB

| Bore | AB | AH | AT | AU | AV | SA | TR | UH | ZT |
|-------|----|----|----|----|----|-----|----|-----|-----|
| φ 125 | 16 | 90 | 7 | 45 | 25 | 250 | 90 | 140 | 270 |

Accessories

● CG TYPE - Male Pivot

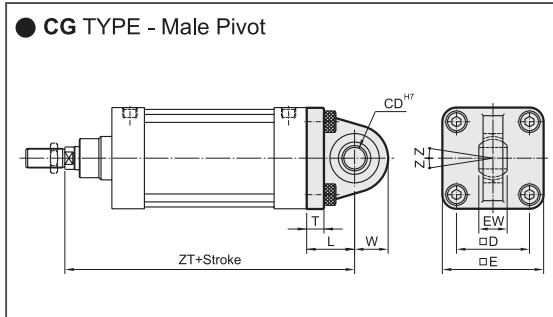

Dimensional Table



| Bore | CD | D | E | EW | L | T | W | Z | ZT |
|-------|----|-----|-----|----|----|----|----|-----|-----|
| φ 125 | 25 | 110 | 140 | 31 | 50 | 17 | 40 | 15° | 275 |

DA

DP

DS

DQ

DB

DN

BN

ST

NT

DU

DJ

TA

GP

GS

GM

GT

RT

CT

CH

● CD TYPE

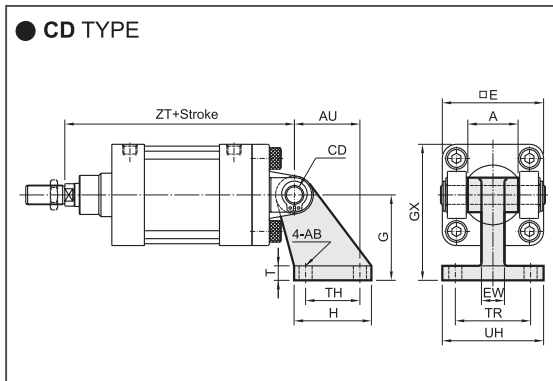

Dimensional Table



| Bore | A | AB | AU | CD | E | EW | T | G | GX |
|-------|----|----|----|----|-----|----|----|----|-----|
| φ 125 | 70 | 14 | 70 | 25 | 140 | 25 | 20 | 90 | 160 |

| Bore | H | TH | TR | UH | ZT |
|-------|----|----|----|-----|-----|
| φ 125 | 90 | 60 | 94 | 124 | 275 |

● CB Pin TYPE

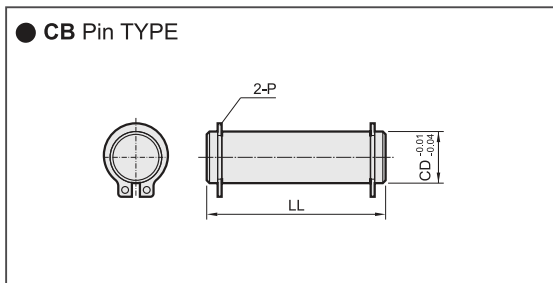

Dimensional Table



| Bore | CD | LL | P |
|-------|----|-----|--------|
| φ 125 | 25 | 139 | STW-25 |

Accessories

● Y Rod Clevis (With Pin)

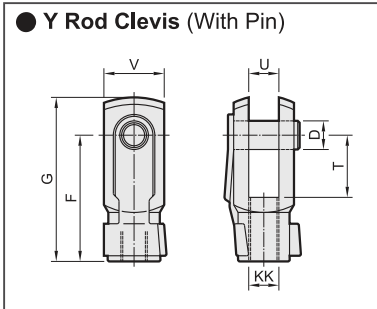

Dimensional Table

| Type | Bore | D | F | G | KK | T | U | V |
|--------------------|-------|----|-----|-----|-----------|----|----|----|
| Y-M27 × 2.0 | φ 125 | 30 | 110 | 155 | M27 × 2.0 | 54 | 30 | 55 |



| Type | Filename |
|--------------------|----------|
| Y-M27 × 2.0 | YM27200 |

● Oscillating Eye

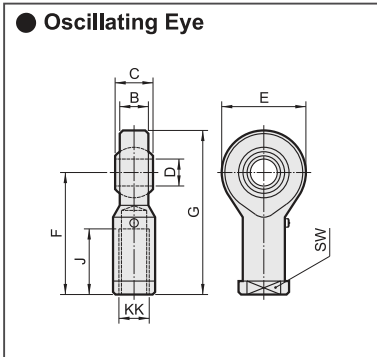

Dimensional Table

| Type | Bore | B | C | D | E | F | G | J | KK | SW |
|--------------------|-------|----|----|----|----|-----|-----|----|-----------|----|
| G-M27 × 2.0 | φ 125 | 25 | 37 | 30 | 70 | 110 | 145 | 50 | M27 × 2.0 | 41 |



| Type | Filename |
|--------------------|----------|
| G-M27 × 2.0 | GM27200 |

● Compensating Joint

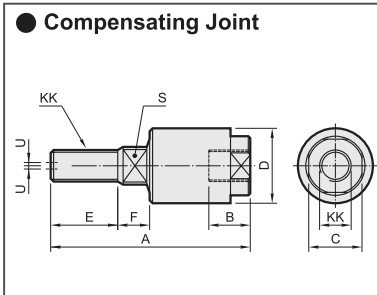

Dimensional Table

| Type | Bore | A | B | C | D | E | F | KK | S | U |
|--------------------|-------|-----|----|----|----|----|----|-----------|----|------|
| K-M27 × 2.0 | φ 125 | 153 | 33 | 41 | 63 | 63 | 22 | M27 × 2.0 | 27 | 1.25 |



| Type | Filename |
|--------------------|----------|
| K-M27 × 2.0 | KM27200 |

● Mounting Nut

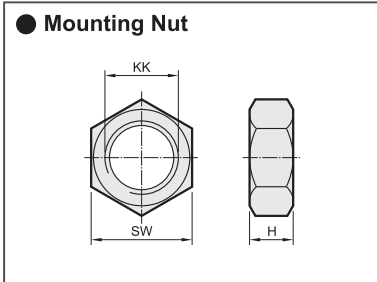

Dimensional Table

| Type | Bore | H | KK | SW |
|--------------------|-------|---|-----------|----|
| N-M27 × 2.0 | φ 125 | 8 | M27 × 2.0 | 35 |



| Type | Filename |
|--------------------|----------|
| N-M27 × 2.0 | NM27200 |

Dimensional features

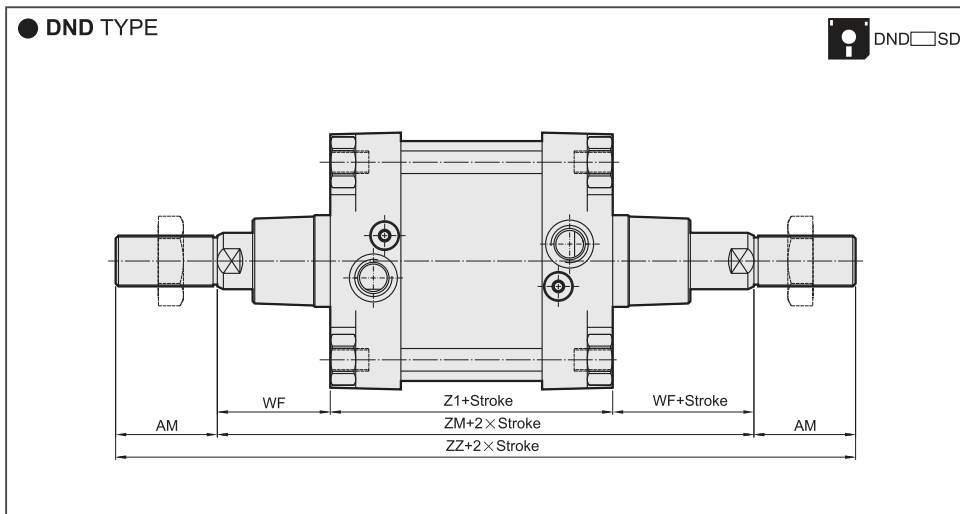
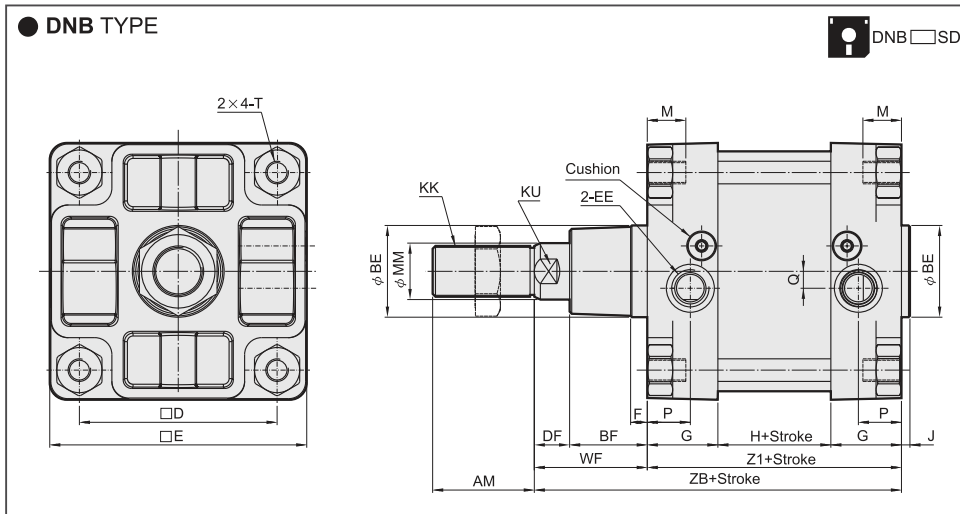

DA

DP

DS

DQ

DB

DN

BN

ST

NT

DU

DJ

TA

GP

GS

GM

GT

RT

CT

CH

Dimensional Table

| Bore | AM | BE | BF | D | DF | E | EE | F | G | H | J | KK | KU | M | MM | P | Q | T | WF | Z1 | ZB | ZM | ZZ |
|-------|----|----|----|-----|----|-----|-------|----|----|----|---|---------|----|----|----|------|----|-----|----|-----|-----|-----|-----|
| φ 160 | 72 | 65 | 55 | 140 | 25 | 182 | G 3/4 | 10 | 50 | 80 | 6 | M36×2.0 | 36 | 27 | 40 | 30.5 | 12 | M16 | 80 | 180 | 260 | 340 | 484 |

Dimensional features

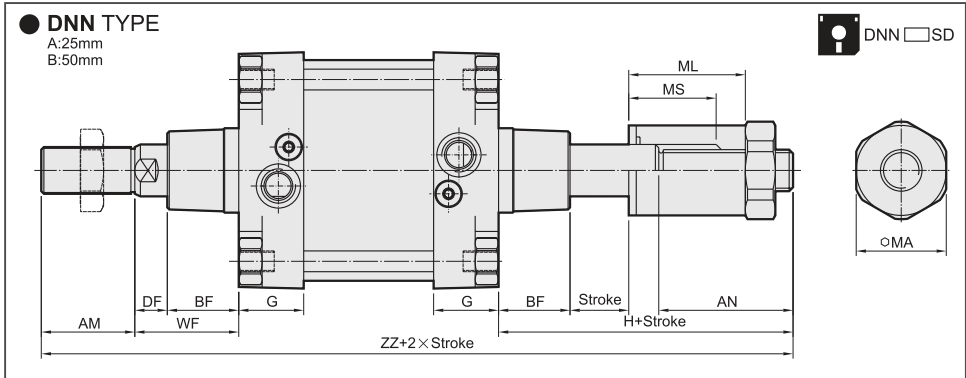

Dimensional Table

| Bore | AM | AN | | BF | DF | G | H | | MA | MB | ME | ML | | MS | | WF | ZZ | |
|-------|----|----|----|----|----|----|-----|-----|----|----|----|----|----|----|----|----|-----|-----|
| | | A | B | | | | A | B | | | | A | B | A | B | | | |
| φ 160 | 72 | 63 | 88 | 55 | 25 | 50 | 134 | 159 | 55 | — | — | 55 | 80 | 37 | 62 | 80 | 466 | 491 |

Accessories

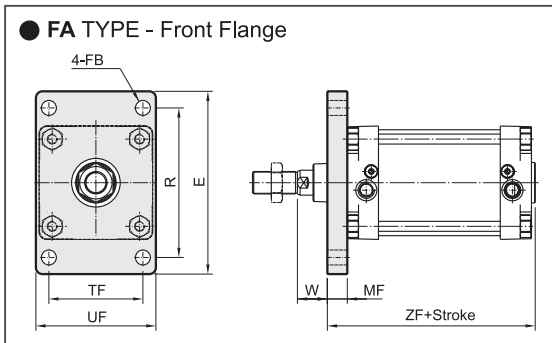

Dimensional Table

DN □ FA

| Bore | E | FB | MF | R | TF | UF | W | ZF |
|-------|-----|----|----|-----|-----|-----|----|-----|
| φ 160 | 280 | 18 | 20 | 230 | 115 | 180 | 60 | 206 |

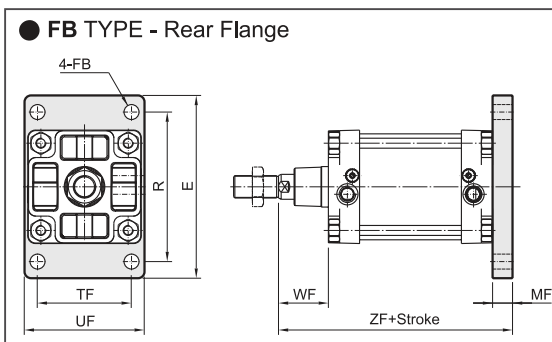

Dimensional Table

DN □ FB

| Bore | E | FB | MF | R | TF | UF | WF | ZF |
|-------|-----|----|----|-----|-----|-----|----|-----|
| φ 160 | 280 | 18 | 20 | 230 | 115 | 180 | 80 | 280 |

Accessories

● TC TYPE - Intermediate Pivot

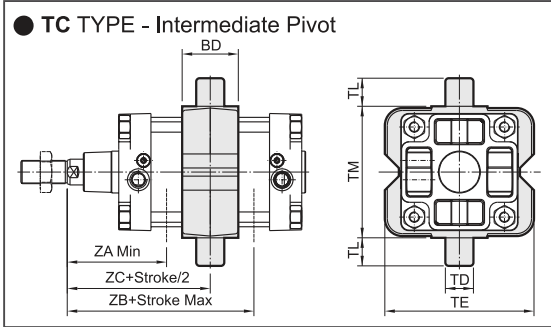

Dimensional Table



DN □ TC

| Bore | BD | TD | TE | TL | TM | ZA | ZB | ZC |
|-------|----|----|-----|----|-----|-----|-----|-----|
| φ 160 | 45 | 32 | 192 | 32 | 200 | 153 | 187 | 170 |

DA

DP

DS

DQ

DB

DN

BN

ST

NT

DU

DJ

TA

GP

GS

GM

GT

RT

CT

CH

● CA TYPE - Male Pivot

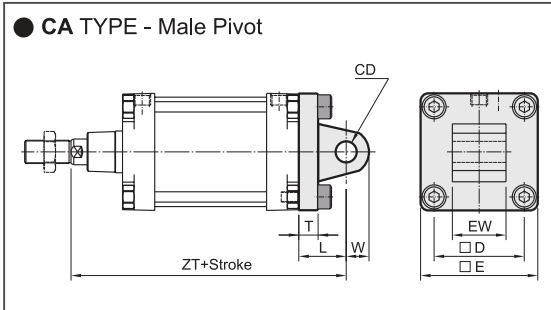

Dimensional Table



DN □ CA

| Bore | CD | D | E | EW | L | T | W | ZT |
|-------|----|-----|-----|----|----|----|----|-----|
| φ 160 | 30 | 140 | 180 | 90 | 55 | 20 | 30 | 315 |

● CB TYPE - Female Pivot

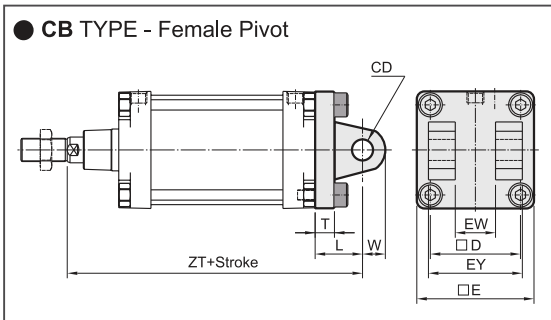

Dimensional Table



DN □ CB

| Bore | CD | D | E | EW | EY | L | T | W | ZT |
|-------|----|-----|-----|----|-----|----|----|----|-----|
| φ 160 | 30 | 140 | 180 | 90 | 170 | 55 | 20 | 30 | 315 |

● LB TYPE - Foot Mounting

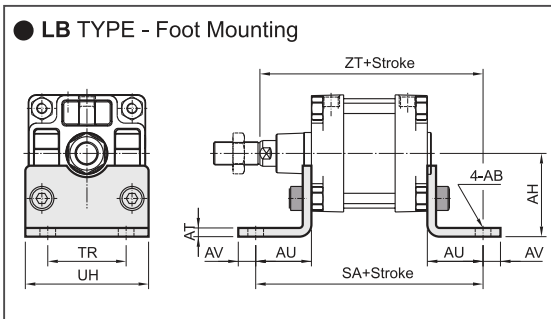

Dimensional Table



DN □ LB

| Bore | AB | AH | AT | AU | AV | SA | TR | UH | ZT |
|-------|----|-----|----|----|----|-----|-----|-----|-----|
| φ 160 | 18 | 115 | 10 | 60 | 15 | 300 | 115 | 180 | 320 |

Accessories

● Y Rod Clevis (With Pin)

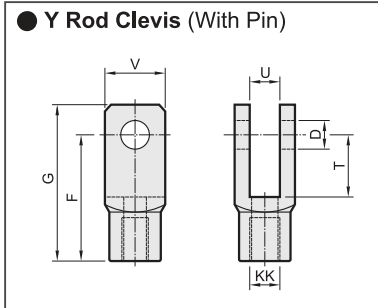

Dimensional Table

| Type | Bore | D | F | G | KK | T | U | V |
|-----------|-------|----|-----|-----|---------|----|----|----|
| Y-M36×2.0 | φ 160 | 35 | 144 | 189 | M36×2.0 | 72 | 35 | 70 |



| Type | Filename |
|-----------|----------|
| Y-M36×2.0 | YM36200 |

● Mounting Nut

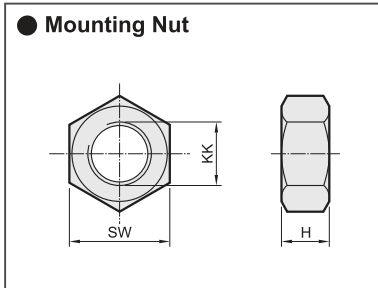

Dimensional Table

| Type | Bore | H | KK | SW |
|-----------|-------|----|---------|----|
| N-M36×2.0 | φ 160 | 18 | M36×2.0 | 55 |



| Type | Filename |
|-----------|----------|
| N-M36×2.0 | NM36200 |

● Y & CA / CB Pin TYPE

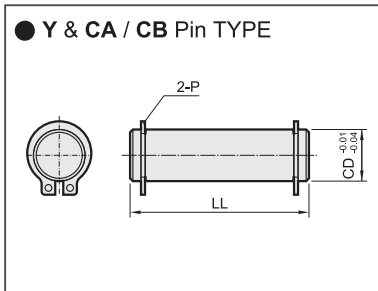

Dimensional Table



DN □ PIN

| Bore | CD | | LL | | P | |
|-------|----|-------|----|-------|--------|--------|
| | Y | CA/CB | Y | CA/CB | Y | CA/CB |
| φ 160 | 35 | 30 | 86 | 186 | STW-35 | STW-30 |

Cylinder Weight (Including The Mounting Nut)

Unit: kg

| Bore | Basic weight DNB | Stroke 25 mm DNB | Basic weight DND | Stroke 25 mm DND | Basic weight DNN | Stroke 25 mm DNN | Basic weight DNN | Stroke 25 mm DNN |
|-------|------------------|------------------|------------------|------------------|------------------|------------------|------------------|------------------|
| | φ 125 | 6.62 | 0.4 | 7.53 | 0.56 | 8.52 | 0.56 | 8.93 |
| φ 160 | 14.8 | 0.9 | 17.04 | 1.13 | 17.64 | 1.13 | 18.24 | 1.13 |

Mounting Weight (Including The Mounting Screws)

Unit: kg

| Bore | FA FB | CA | CB | LB | TC | Y+PIN | I | Nut(Rod) | Sensor switch |
|-------|-------|------|------|------|------|-------|------|----------|---------------|
| φ 125 | 4.02 | 3.78 | 3.56 | 2.50 | 2.75 | 1.81 | 1.40 | 0.05 | 0.066 |
| φ 160 | 7.17 | 7.40 | 7.14 | 4.60 | 5.13 | 3.12 | 1.90 | 0.2 | 0.086 |