

14MPa Double acting hydraulic cylinders

DHB

Double Acting - Standard Type



DHD

Double Acting - Double End Rod Type



DHN-A, DHN-B

A:25mm
B:50mm

Double Acting - Adjustable Forward Stroke Cylinder

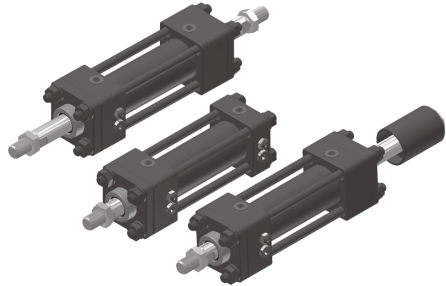







- Hydro-cylinders of this series can be added with cushions.

Specification

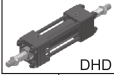
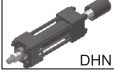
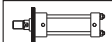
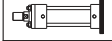
Bore sizes of cylinder (mm)	φ 40	φ 50	φ 63	φ 80	φ 100	φ 125	φ 150
Standard stroke (mm)	50,100,150,200,250,300,350,400,450,500						
The range of stroke (mm)	Max. 1500			Max. 1900			
Power fluid	Filtered oil						
Material of cylinder barrel	Carbon steel STKM 13C						
The range of pressure (MPa)	14(140Kg/cm ²)						
The range of temperature (°C)	-10~+60						

How to order

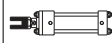
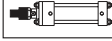
2 DHN 50 B 100 (B C) - A LB - Y

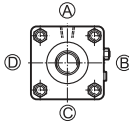
Seal material	Type	Bore	Cushion	Stroke	Cushion adjustment location	Adjustable stroke	Accessory	
 DHB  DHD  DHN	40—φ 40mm 50—φ 50mm 63—φ 63mm 80—φ 80mm 100—φ 100mm 125—φ 125mm 150—φ 150mm	R: Rod cover with cushion H: End cap with cushion B: Both end with cushion N: No cushion	50—50mm 100—100mm 150—150mm 200—200mm 250—250mm 300—300mm 350—350mm 400—400mm 450—450mm 500—500mm	None: standard A: Adjustable 25mm B: Adjustable 50mm Note: this number can only be used for the adjustable type.	 FA  FB  LA  LB  CA  CB  TC  Y  I			
	※Cushion position adjustment: Ports Location B Cushion adjustment location C							
	Those without marks are in standard type, and its positions are described as followed. (A) Ports Location (B) Cushion adjustment location							
Symbol	Seal material	Kind of fluid						
1	NBR	○	○	×	○	○		
2	PU	○	×	×	△	△		
3	VITON	○	×	○	○	○		

Note: ○: allowable ×: unallowable △: consult us

Standard stroke

Unit : mm

Bore	50	100	150	200	250	300	350	400	450	500
φ 40	●	●	●	●	●	●	—	—	—	—
φ 50	●	●	●	●	●	●	—	—	—	—
φ 63	●	●	●	●	●	●	●	●	●	●
φ 80	●	●	●	●	●	●	●	●	●	●
φ 100	●	●	●	●	●	●	●	●	●	●
φ 125	●	●	●	●	●	●	●	●	●	●
φ 150	●	●	●	●	●	●	●	●	●	●

Note: May to order of unstandard stroke

Stroke tolerance

Unit : mm

Stroke	~100	101~250	251~630	631~1000	1001~1600	1601~2000
Tolerance	+0.8	+1.0	+1.25	+1.4	+1.6	+1.8
	0	0	0	0	0	0

Theoretic force

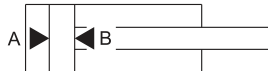

Unit : KN

Bore (mm)	Rod (mm)	Pressure area (mm ²)	Operating pressure (MPa)									
			6	7	8	9	10	11	12	13	14	
φ 40	φ 20	A	1256	7.54	8.79	10.05	11.30	12.56	13.82	15.07	16.33	17.58
		B	942	5.65	6.59	7.54	8.48	9.42	10.36	11.30	12.25	13.19
φ 50	φ 25	A	1963	11.78	13.74	15.70	17.67	19.63	21.59	23.56	25.52	27.48
		B	1472	8.83	10.30	11.78	13.25	14.72	16.19	17.66	19.14	20.61
φ 63	φ 35	A	3116	18.70	21.81	24.93	28.06	31.18	34.28	37.39	40.51	43.62
		B	2154	12.92	15.08	17.23	19.39	21.54	23.69	25.85	28.00	30.16
φ 80	φ 40	A	5024	30.14	35.17	40.19	45.22	50.24	55.26	60.29	65.31	70.34
		B	3768	22.61	26.38	30.14	33.91	37.68	41.45	45.22	48.98	52.75
φ 100	φ 50	A	7850	47.10	54.95	62.80	70.65	78.50	86.35	94.20	102.05	109.90
		B	5887	35.32	41.21	47.10	52.98	58.87	64.76	70.64	76.53	82.42
φ 125	φ 60	A	12266	73.60	85.86	98.13	110.39	122.66	134.93	147.19	159.46	171.72
		B	9440	56.64	66.08	75.52	84.96	94.40	103.84	113.28	122.72	132.16
φ 150	φ 80	A	17662	105.97	123.63	141.30	158.96	176.62	194.28	211.94	229.61	247.27
		B	12638	75.83	88.47	101.10	113.74	126.38	139.02	151.66	164.29	176.93

The method of calculation (Hydraulic cylinders' force)

$$F = P \times A - f$$

F: Cylinders' force

(N)

P: Operating pressure

(MPa)

TC

TS

RP

HC

HC_M

HCK

TH

DO

DX
DW

DM

DH

DK

How to order the seal kit

DHBSK

Bore	Seal kit
40	DHBSK40 - Including No.13,14,15,16,17,18
50	DHBSK50 - Including No.13,14,15,16,17,18
63	DHBSK63 - Including No.13,14,15,16,17,18
80	DHBSK80 - Including No.13,14,15,16,17,18
100	DHBSK100 - Including No.13,14,15,16,17,18
125	DHBSK125 - Including No.13,14,15,16,17,18
150	DHBSK150 - Including No.13,14,15,16,17,18

DHDSK

Bore	Seal kit
40	DHDSK40 - Including No.10,11,12,13,14,15
50	DHDSK50 - Including No.10,11,12,13,14,15
63	DHDSK63 - Including No.10,11,12,13,14,15
80	DHDSK80 - Including No.10,11,12,13,14,15
100	DHDSK100 - Including No.10,11,12,13,14,15
125	DHDSK125 - Including No.10,11,12,13,14,15
150	DHDSK150 - Including No.10,11,12,13,14,15

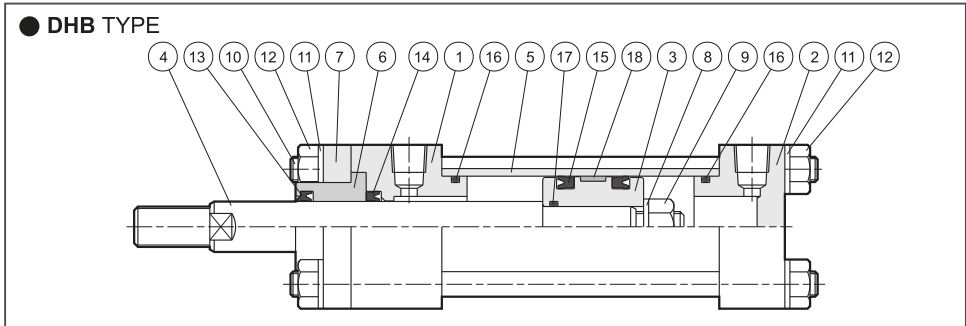

Parts List

No.	Part name	Quantity	No.	Part name	Quantity	No.	Part name	Quantity
1	Rod cover	1	7	End plate	1	13	Dust wiper	1
2	Head cover	1	8	Spring washer	1	14	Rod packing	1
3	Piston	1	9	Piston nut	1	15	Piston packing	2
4	Piston rod	1	10	Tie bolt	4	16	Cylinder gasket	2
5	Cylinder tube	1	11	Spring washer	8	17	Piston gasket	1
6	Rod bush	1	12	Nut	8	18	Wearing ring	1

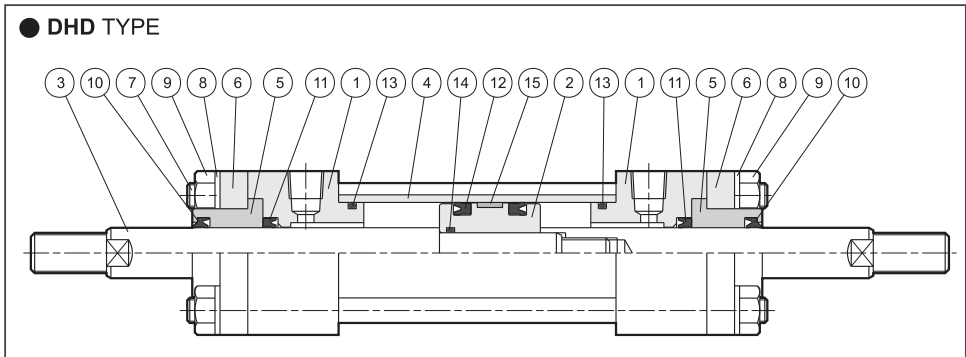

Parts List

No.	Part name	Quantity	No.	Part name	Quantity	No.	Part name	Quantity
1	Rod cover	2	6	End plate	2	11	Rod packing	2
2	Piston	1	7	Tie bolt	4	12	Piston packing	2
3	Piston rod	1	8	Spring washer	8	13	Cylinder gasket	2
4	Cylinder tube	1	9	Nut	8	14	Piston gasket	1
5	Rod bush	2	10	Dust wiper	2	15	Wearing ring	1

Dimensional features

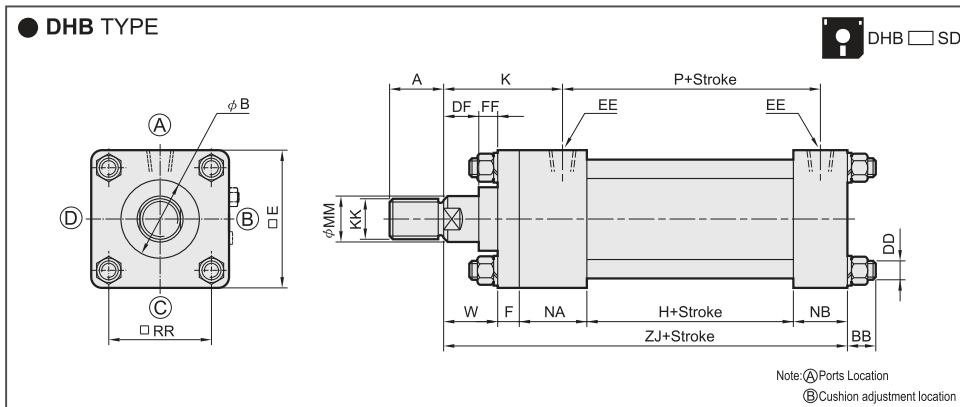

Dimensional Table

Bore	A	B	BB	DD	DF	E	EE	F	FF	H	K	KK	MM	NA	NB	P	RR	W	ZJ
φ 40	30	35	12	M10×1.25	14	65	PT 1/4	11	11	60	60	M16×1.5	20	36	26	84	45	25	158
φ 50	35	40	12	M10×1.25	16	75	PT 3/8	13	9	60	66	M22×1.5	25	42	34	88	52	25	174
φ 63	40	50	14	M12×1.5	21	90	PT 3/8	15	9	65	73	M30×1.5	35	42	34	93	63	30	186
φ 80	45	55	18	M16×1.5	23	110	PT 1/2	18	7	65	79	M30×1.5	40	46	39	95	80	30	198
φ 100	50	65	22	M18×1.5	33	135	PT 1/2	20	7	74	95	M40×2.0	50	50	40	104	102	40	224
φ 125	60	75	25	M22×1.5	38	165	PT 3/4	25	7	74	109	M48×2.0	60	58	47	112	122	45	249
φ 150	70	100	28	M26×1.5	43	195	PT 3/4	30	7	90	119	M72×2.0	80	58	48	128	148	50	276

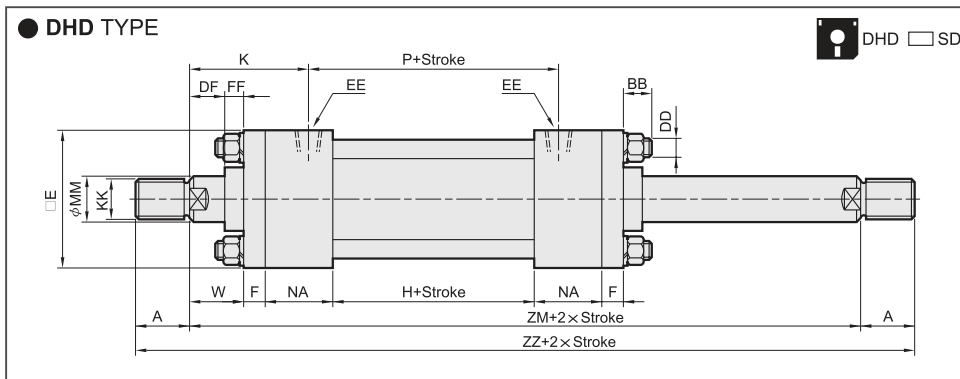

Dimensional Table

Bore	A	B	BB	DD	DF	E	EE	F	FF	H	K	KK	MM	NA	P	RR	W	ZM	ZZ
φ 40	30	35	12	M10×1.25	14	65	PT 1/4	11	11	60	60	M16×1.5	20	36	84	45	25	204	264
φ 50	35	40	12	M10×1.25	16	75	PT 3/8	13	9	60	66	M22×1.5	25	42	88	52	25	220	290
φ 63	40	50	14	M12×1.5	21	90	PT 3/8	15	9	65	73	M30×1.5	35	42	93	63	30	239	319
φ 80	45	55	18	M16×1.5	23	110	PT 1/2	18	7	65	79	M30×1.5	40	46	95	80	30	253	343
φ 100	50	65	22	M18×1.5	33	135	PT 1/2	20	7	74	95	M40×2.0	50	50	104	102	40	294	394
φ 125	60	75	25	M22×1.5	38	165	PT 3/4	25	7	74	109	M48×2.0	60	58	112	122	45	330	450
φ 150	70	100	28	M26×1.5	43	195	PT 3/4	30	7	90	119	M72×2.0	80	58	128	148	50	366	506

- TC
- TS
- RP
- HC
- HC_M
- HCK
- TH
- DO
- DX
- DW
- DM
- DH
- DK

Dimensional features

● FA TYPE - Front Flange

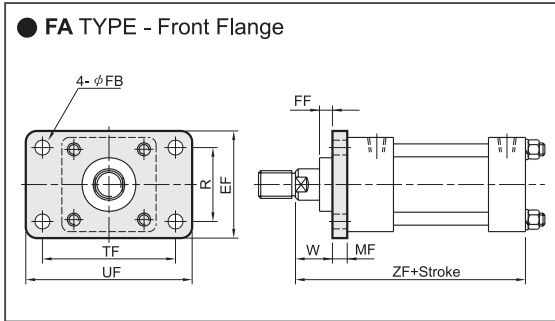

Dimensional Table



Bore	EF	FB	FF	MF	R	TF	UF	W	ZF
φ 40	69	11	11	11	46	95	118	25	158
φ 50	85	11	9	13	58	115	145	25	174
φ 63	98	14	9	15	65	132	165	30	186
φ 80	118	18	7	18	87	155	190	30	198
φ 100	150	22	7	20	109	190	230	40	224
φ 125	175	24	7	25	130	224	272	45	249
φ 150	210	28	7	30	155	270	320	50	276

● FB TYPE - Rear Flange

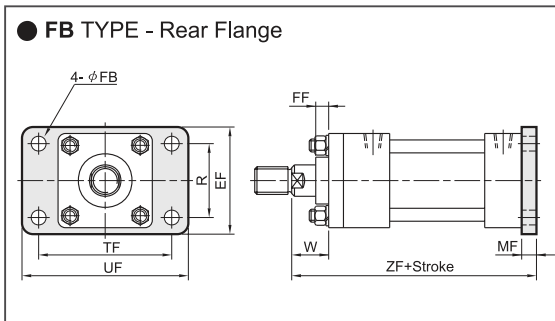

Dimensional Table



Bore	EF	FB	FF	MF	R	TF	UF	W	ZF
φ 40	69	11	11	11	46	95	118	25	169
φ 50	85	11	9	13	58	115	145	25	187
φ 63	98	14	9	15	65	132	165	30	201
φ 80	118	18	7	18	87	155	190	30	216
φ 100	150	22	7	20	109	190	230	40	244
φ 125	175	24	7	25	130	224	272	45	274
φ 150	210	28	7	30	155	270	320	50	306

● CA TYPE - Male Pivot

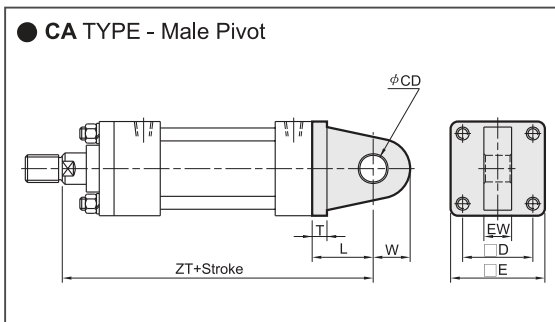

Dimensional Table



Bore	CD	D	E	EW	L	T	W	ZT
φ 40	16	45	65	20	38	11	16	196
φ 50	20	52	75	25	45	13	20	219
φ 63	25	63	90	30	54	15	25	240
φ 80	30	80	110	35	71	18	30	269
φ 100	40	102	135	40	86	20	40	310
φ 125	50	122	165	50	110	25	50	359
φ 150	60	148	195	60	109	30	60	385

● CB TYPE - Female Pivot

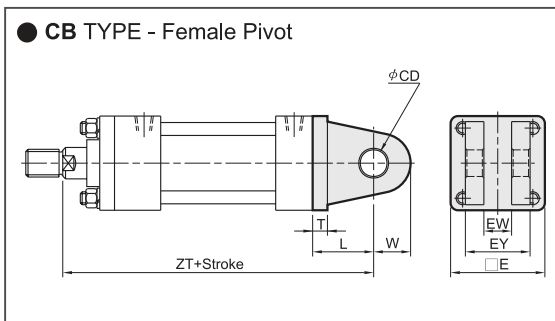

Dimensional Table



Bore	CD	E	EW	EY	L	T	W	ZT
φ 40	16	65	20	50	38	11	16	196
φ 50	20	75	25	57	45	13	20	219
φ 63	25	90	30	70	54	15	25	240
φ 80	30	110	35	80	71	18	30	269
φ 100	40	135	40	100	86	20	40	310
φ 125	50	165	50	126	110	25	50	359
φ 150	60	195	60	160	109	30	60	385

Dimensional features

● LA TYPE - Side lugs

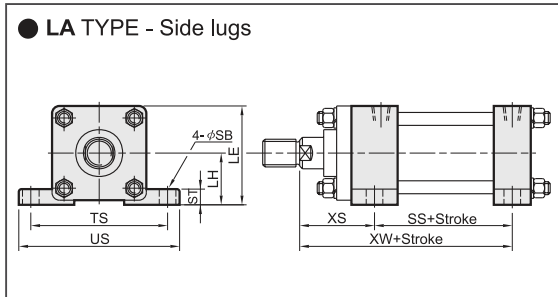

Dimensional Table



Bore	LE	LH	SB	SS	ST	TS	XS	XW	US
φ 40	70	37.5	11	91	14	95	54	145	118
φ 50	82.5	45	11	98	17	115	59	157	145
φ 63	95	50	14	103	19	132	66	169	165
φ 80	115	60	18	107.5	25	155	71	178.5	190
φ 100	138.5	71	22	119	27	190	85	204	230
φ 125	167.5	85	24	126.5	32	224	99	225.5	272
φ 150	203.5	106	28	143	37	270	109	252	320

TC

TS

RP

HC

HC_M

HCK

TH

DO

DX

DW

DM

DH

DK

● LB TYPE - Foot Mounting

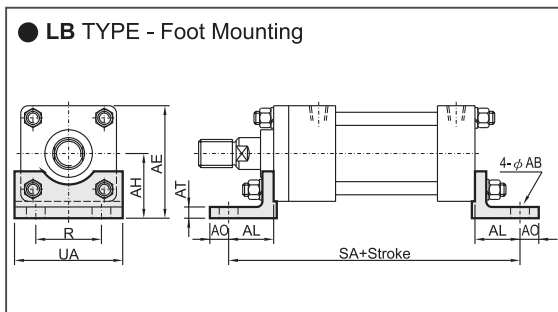

Dimensional Table



Bore	AB	AE	AH	AL	AO	AT	R	SA	UA
φ 40	11	75.5	43	32.5	13	8	46	198	69
φ 50	11	87.5	50	32.5	15	8	58	214	85
φ 63	14	105	60	37	18	10	65	230	98
φ 80	18	127	72	49	20	12	87	266	118
φ 100	22	152.5	85	58	23	12	109	300	150
φ 125	24	187.5	105	68.5	29	15	130	341	175
φ 150	28	220.5	123	74.5	30	18	155	375	210

● TC TYPE - Intermediate Pivot

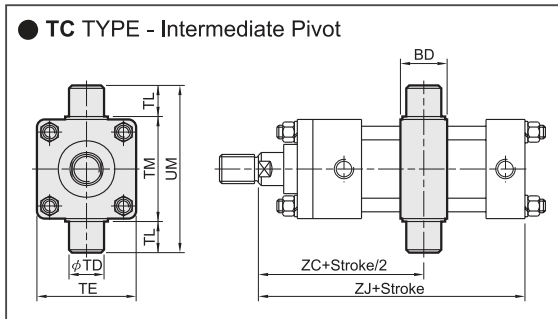

Dimensional Table



Bore	BD	TE	TD	TL	TM	UM	ZC	ZJ
φ 40	28	65	20	20	69	109	102	158
φ 50	33	75	25	25	85	135	110	174
φ 63	38	90	30	30	98	158	119.5	186
φ 80	38	110	30	30	118	178	126.5	198
φ 100	48	135	40	40	145	225	147	224
φ 125	58	165	50	50	175	275	165	249
φ 150	73	195	60	63	205	331	183	276

Dimensional features

● FA TYPE - Front Flange

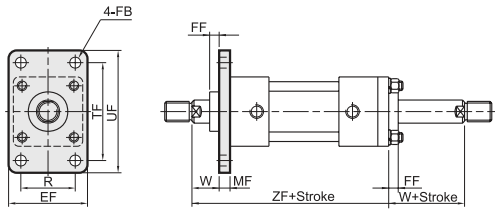

Dimensional Table



Bore	EF	FB	FF	MF	R	TF	UF	W	ZF
φ 40	69	11	11	11	46	95	118	25	179
φ 50	85	11	9	13	58	115	145	25	195
φ 63	98	14	9	15	65	132	165	30	209
φ 80	118	18	7	18	87	155	190	30	223
φ 100	150	22	7	20	109	190	230	40	254
φ 125	175	24	7	25	130	224	272	45	285
φ 150	210	28	7	30	155	270	320	50	316

● LA TYPE - Side lugs

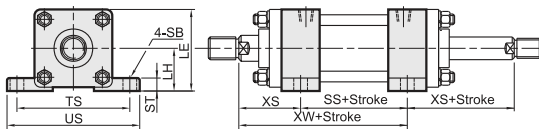

Dimensional Table



Bore	LE	LH	SB	SS	ST	TS	XS	XW	US
φ 40	70	37.5	11	96	14	95	54	150	118
φ 50	82.5	45	11	102	17	115	59	161	145
φ 63	95	50	14	107	19	132	66	173	165
φ 80	115	60	18	111	25	155	71	182	190
φ 100	138.5	71	22	124	27	190	85	209	230
φ 125	167.5	85	24	132	32	224	99	231	272
φ 150	203.5	106	28	148	37	270	109	257	320

● LB TYPE - Foot Mounting

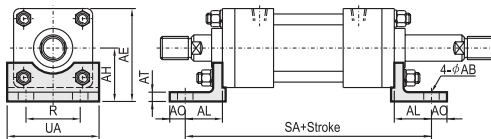

Dimensional Table



Bore	AB	AE	AH	AL	AO	AT	R	SA	UA
φ 40	11	75.5	43	32.5	13	8	46	219	69
φ 50	11	87.5	50	32.5	15	8	58	235	85
φ 63	14	105	60	37	18	10	65	253	98
φ 80	18	127	72	49	20	12	87	291	118
φ 100	22	152.5	85	58	23	12	109	330	150
φ 125	24	187.5	105	68.5	29	15	130	377	175
φ 150	28	220.5	123	74.5	30	18	155	415	210

● TC TYPE - Intermediate Pivot

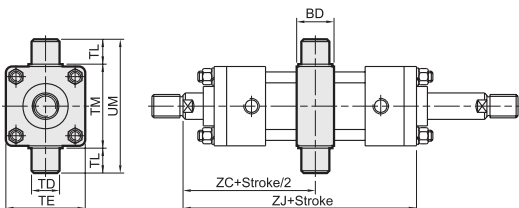

Dimensional Table



Bore	BD	TE	TD	TL	TM	UM	ZC	ZJ
φ 40	28	65	20	20	69	109	102	179
φ 50	33	75	25	25	85	135	110	195
φ 63	38	90	30	30	98	158	119.5	209
φ 80	38	110	30	30	118	178	126.5	223
φ 100	48	135	40	40	145	225	147	254
φ 125	58	165	50	50	175	275	165	285
φ 150	73	195	60	63	205	331	183	316

Dimensional features

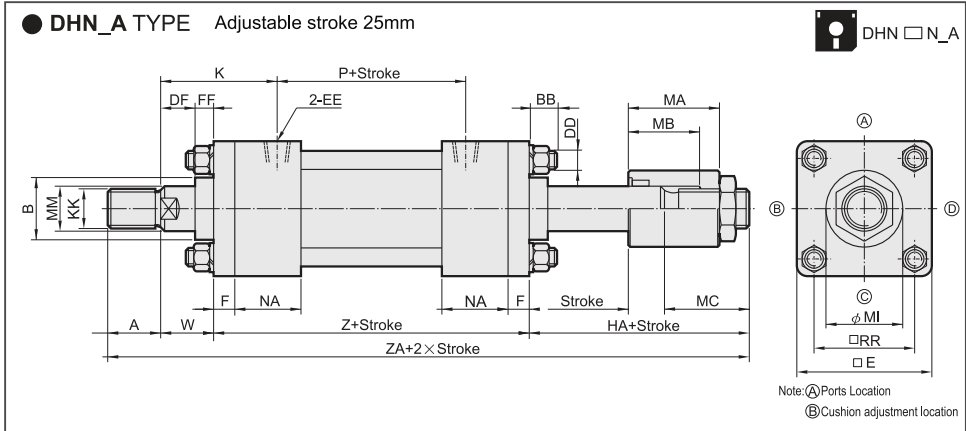

Dimensional Table

Bore	A	B	BB	DD	DF	E	EE	F	FF	HA	K	KK	MA	MB	MC	MI	MM	NA	P	RR	W	Z	ZA
φ 40	30	35	12	M10×1.25	14	65	PT1/4	11	11	71	59	M16×1.5	60	45	51	42	20	36	86	45	25	154	280
φ 50	35	40	12	M10×1.25	16	75	PT3/8	13	9	77	65	M22×1.5	63	45	57	50	25	42	90	52	25	170	307
φ 63	40	50	14	M12×1.5	21	90	PT3/8	15	9	81	72	M30×1.5	65	45	61	60	35	42	95	63	30	179	330
φ 80	45	55	18	M16×1.5	23	110	PT1/2	18	7	81	76	M30×1.5	65	45	61	70	40	46	101	80	30	193	349
φ 100	50	65	22	M18×1.5	33	135	PT1/2	20	7	88	92	M40×2.0	70	45	68	80	50	50	110	102	40	214	392
φ 125	60	75	25	M22×1.5	38	165	PT3/4	25	7	92	108	M48×2.0	75	46	72	85	60	58	114	122	45	240	437
φ 150	70	100	28	M26×1.5	43	195	PT3/4	30	7	112	118	M72×2.0	85	46	92	115	80	58	130	148	50	266	498

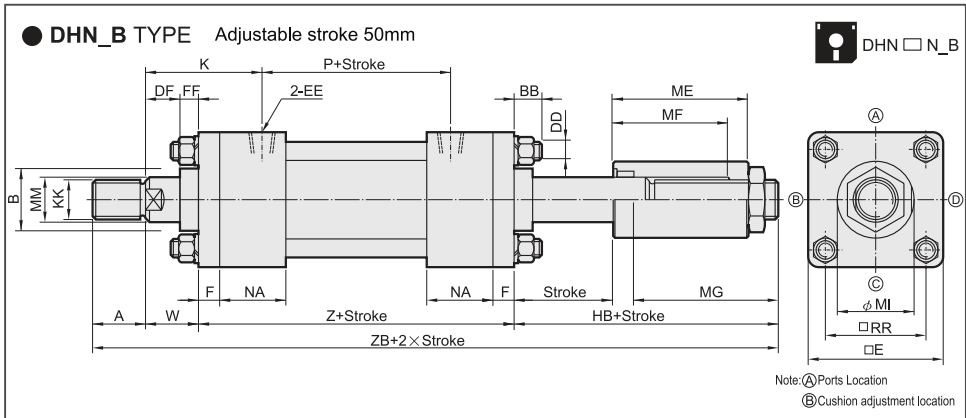

Dimensional Table

Bore	A	B	BB	DD	DF	E	EE	F	FF	HB	K	KK	ME	MF	MG	MI	MM	NA	P	RR	W	Z	ZB
φ 40	30	35	12	M10×1.25	14	65	PT1/4	11	11	96	59	M16×1.5	85	70	76	42	20	36	86	45	25	154	305
φ 50	35	40	12	M10×1.25	16	75	PT3/8	13	9	102	65	M22×1.5	88	70	82	50	25	42	90	52	25	170	332
φ 63	40	50	14	M12×1.5	21	90	PT3/8	15	9	106	72	M30×1.5	90	70	86	60	35	42	95	63	30	179	355
φ 80	45	55	18	M16×1.5	23	110	PT1/2	18	7	106	76	M30×1.5	90	70	86	70	40	46	101	80	30	193	374
φ 100	50	65	22	M18×1.5	33	135	PT1/2	20	7	113	92	M40×2.0	95	70	93	80	50	50	110	102	40	214	417
φ 125	60	75	25	M22×1.5	38	165	PT3/4	25	7	117	108	M48×2.0	100	71	97	85	60	58	114	122	45	240	462
φ 150	70	100	28	M26×1.5	43	195	PT3/4	30	7	137	118	M72×2.0	110	71	117	115	80	58	130	148	50	266	523

TC

TS

RP

HC

HC_M

HCK

TH

DO

DX

DW

DM

DH

DK

Dimensional features

Adjustable stroke 25mm

● FA TYPE

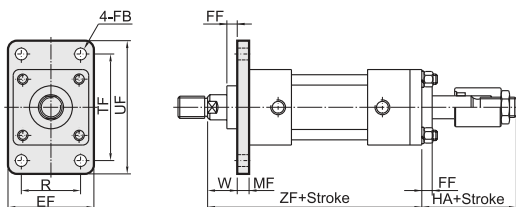

DHN □ N_A-FA

Bore	EF	FB	FF	HA	MF	R	TF	UF	W	ZF
φ 40	69	11	11	71	11	46	95	118	25	179
φ 50	85	11	9	77	13	58	115	145	25	195
φ 63	98	14	9	81	15	65	132	165	30	209
φ 80	118	18	7	81	18	87	155	190	30	223
φ 100	150	22	7	88	20	109	190	230	40	254
φ 125	175	24	7	92	25	130	224	272	45	285
φ 150	210	28	7	112	30	155	270	320	50	316

● LA TYPE

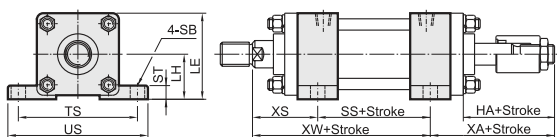

DHN □ N_A-LA

Bore	LE	LH	HA	SB	SS	ST	TS	XA	XS	XW	US
φ 40	70	37.5	71	11	96	14	95	100	54	150	118
φ 50	82.5	45	77	11	102	17	115	111	59	161	145
φ 63	95	50	81	14	107	19	132	117	66	173	165
φ 80	115	60	81	18	111	25	155	122	71	182	190
φ 100	138.5	71	88	22	124	27	190	133	85	209	230
φ 125	167.5	85	92	24	132	32	224	146	99	231	272
φ 150	203.5	106	112	28	148	37	270	171	109	257	320

● LB TYPE - Foot Mounting

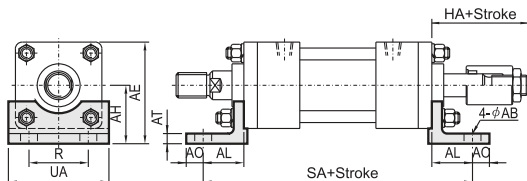

DHN □ N_A-LB

Bore	AB	AE	AH	AL	AO	AT	HA	RA	SA	UA
φ 40	11	75.5	43	32.5	13	8	71	46	219	69
φ 50	11	87.5	50	32.5	15	8	77	58	235	85
φ 63	14	105	60	37	18	10	81	65	253	98
φ 80	18	127	72	49	20	12	81	87	291	118
φ 100	22	152.5	85	58	23	12	88	109	330	150
φ 125	24	187.5	105	68.5	29	15	92	130	377	175
φ 150	28	220.5	123	74.5	30	18	112	155	415	210

● TC TYPE - Intermediate Pivot

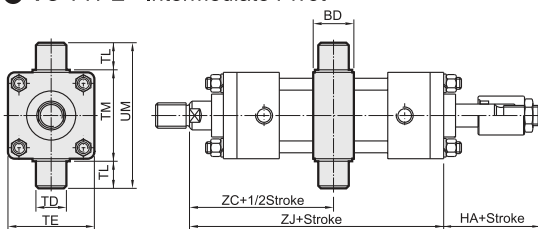

DHN □ N_A-TC

Bore	BD	TE	TD	TL	TM	HA	UM	ZC	ZJ
φ 40	28	65	20	20	69	71	109	102	179
φ 50	33	75	25	25	85	77	135	110	195
φ 63	38	90	30	30	98	81	158	119.5	209
φ 80	38	110	30	30	118	81	178	126.5	223
φ 100	48	135	40	40	145	88	225	147	254
φ 125	58	165	50	50	175	92	275	165	285
φ 150	73	195	60	63	205	112	331	183	316

Dimensional features

Adjustable stroke 50mm

● FA TYPE

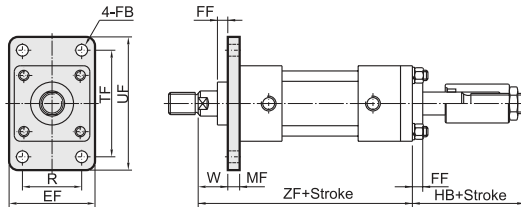

DHN □ N_B-FA

Bore	EF	FB	FF	HB	MF	R	TF	UF	W	ZF
φ 40	69	11	11	96	11	46	95	118	25	179
φ 50	85	11	9	102	13	58	115	145	25	195
φ 63	98	14	9	106	15	65	132	165	30	209
φ 80	118	18	7	106	18	87	155	190	30	223
φ 100	150	22	7	113	20	109	190	230	40	254
φ 125	175	24	7	117	25	130	224	272	45	285
φ 150	210	28	7	137	30	155	270	320	50	316

● LA TYPE - Side lugs

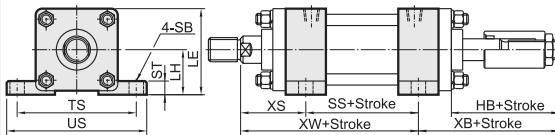

DHN □ N_B-LA

Bore	LE	LH	HB	SB	SS	ST	TS	XB	XS	XW	US
φ 40	70	37.5	96	11	96	14	95	125	54	150	118
φ 50	82.5	45	102	11	102	17	115	136	59	161	145
φ 63	95	50	106	14	107	19	132	142	66	173	165
φ 80	115	60	106	18	111	25	155	147	71	182	190
φ 100	138.5	71	113	22	124	27	190	158	85	209	230
φ 125	167.5	85	117	24	132	32	224	171	99	231	272
φ 150	203.5	106	137	28	148	37	270	196	109	257	320

● LB TYPE - Foot Mounting

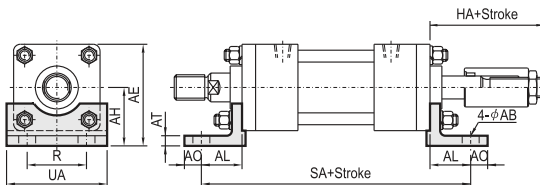

DHN □ N_B-LB

Bore	AB	AE	AH	AL	AO	AT	HB	R	SA	UA
φ 40	11	75.5	43	32.5	13	8	96	46	219	69
φ 50	11	87.5	50	32.5	15	8	102	58	235	85
φ 63	14	105	60	37	18	10	106	65	253	98
φ 80	18	127	72	49	20	12	106	87	291	118
φ 100	22	152.5	85	58	23	12	113	109	330	150
φ 125	24	187.5	105	68.5	29	15	117	130	377	175
φ 150	28	220.5	123	74.5	30	18	137	155	415	210

● TC TYPE - Intermediate Pivot

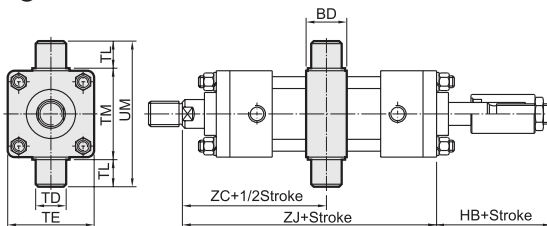

DHN □ N_B-TC

Bore	BD	TE	TD	TL	TM	HB	UM	ZC	ZJ
φ 40	28	65	20	20	69	96	109	102	179
φ 50	33	75	25	25	85	102	135	110	195
φ 63	38	90	30	30	98	106	158	119.5	209
φ 80	38	110	30	30	118	106	178	126.5	223
φ 100	48	135	40	40	145	113	225	147	254
φ 125	58	165	50	50	175	117	275	165	285
φ 150	73	195	60	63	205	137	331	183	316

TC

TS

RP

HC

HC_M

HCK

TH

DO

DX
DW

DM

DH

DK

Accessories

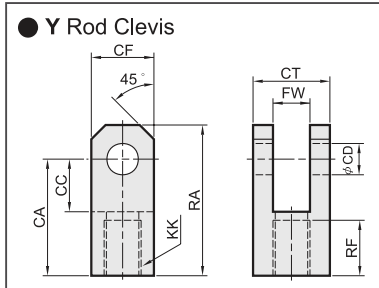

Dimensional Table

Type	Bore	CA	CC	CD	CF	CT	FW	KK	RA	RF	Filename
Y-M16×1.5	φ 40	50	26	16	35	45	20	M16×1.5	66	24	YM16150H
Y-M22×1.5	φ 50	60	30	20	40	50	25	M22×1.5	80	30	YM22150H
Y-M30×1.5	φ 63	80	40	25	50	60	30	M30×1.5	105	40	YM30150M
Y-M30×1.5	φ 80	80	40	30	60	65	35	M30×1.5	110	40	YM30150H
Y-M40×2.0	φ 100	90	50	40	80	90	40	M40×2.0	130	40	YM40200H
Y-M48×2.0	φ 125	110	60	50	100	100	50	M48×2.0	160	50	YM48200H
Y-M72×2.0	φ 150	130	70	60	120	120	60	M72×2.0	190	60	YM72200H

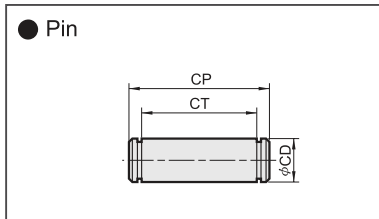

Dimensional Table

Type	Bore	CD		CP		CT		Filename
		Y-PIN	CB-PIN	Y-PIN	CB-PIN	Y-PIN	CB-PIN	
P1659	φ 40	16	16	59	64	46	51	P16059
P2066	φ 50	20	20	66	73	51	58	P20066
P2576	φ 63	25	25	76	86	61	71	P25076
P3081	φ 80	30	30	81	96	66	81	P30081
P40114	φ 100	40	40	114	124	91	101	P40114
P50124	φ 125	50	50	124	150	101	127	P50124
P60156	φ 150	60	60	156	196	121	161	P60156

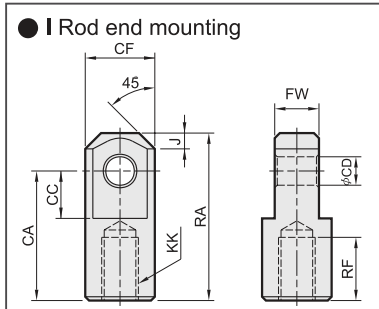

Dimensional Table

Type	Bore	CA	CC	CD	CF	FW	J	KK	RA	RF	Filename
I-M16×1.5	φ 40	55	30	16	40	20	8	M16×1.5	75	20	IM16150H
I-M22×1.5	φ 50	65	35	20	50	25	10	M22×1.5	90	25	IM22150H
I-M30×1.5	φ 63	80	40	25	55	30	12.5	M30×1.5	110	35	IM30150M
I-M30×1.5	φ 80	90	45	30	60	35	15	M30×1.5	125	35	IM30150H
I-M40×2.0	φ 100	105	55	40	80	40	20	M40×2.0	145	40	IM40200H
I-M48×2.0	φ 125	120	65	50	100	50	30	M48×2.0	170	50	IM48200H
I-M72×2.0	φ 150	140	75	60	120	60	30	M72×2.0	200	55	IM72200H

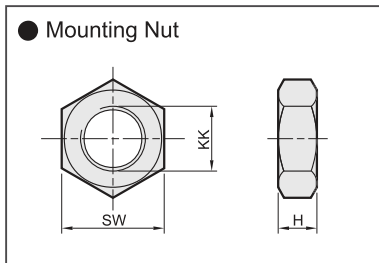



Dimensional Table

Type	Bore	H	KK	SW	Filename
N-M16×1.5	φ 40	8	M16×1.5	24	NM16150H
N-M22×1.5	φ 50	11	M22×1.5	32	NM22150H
N-M30×1.5	φ 63	13	M30×1.5	41	NM30150H
N-M30×1.5	φ 80	13	M30×1.5	41	NM30150H
N-M40×2.0	φ 100	15	M40×2.0	57	NM40200H
N-M48×2.0	φ 125	15	M48×2.0	65	NM48200H
N-M72×2.0	φ 150	20	M72×2.0	φ 100	NM72200H



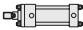

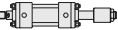
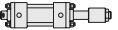
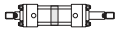





Cylinder weight (including the mounting nut)

Unit: kg

Bore	Basic weight DHB TYPE	Stroke 25 mm DHB TYPE	Basic weight DHD TYPE	Basic weight DHN A TYPE	Basic weight DHN B TYPE	Stroke 25 mm DHD/DHN TYPE
						
φ 40	3.7	0.155	4.8	5.5	5.8	0.21
φ 50	6.2	0.244	8.0	9.1	9.6	0.34
φ 63	8.9	0.421	11.2	12.8	13.4	0.60
φ 80	14.6	0.546	17.3	19.5	20.3	0.80
φ 100	24.2	0.895	28.2	31.3	32.3	1.28
φ 125	40.9	1.462	49.4	53.2	54.4	2.01
φ 150	64.5	2.337	80.5	87.6	89.4	3.31

Mounting weight

Unit: kg

Bore	FA FB		LA	LB	CA	CB+pin	TC	Y+pin	I	Nut (Rod)
										
φ 40	0.3	0.6	0.5	0.6	0.6	0.7	0.6	0.6	0.6	0.02
φ 50	0.8	1.2	0.9	0.8	1.0	1.1	1.0	0.9	0.9	0.04
φ 63	1.3	1.8	1.0	1.4	1.8	2.1	1.2	1.5	1.2	0.08
φ 80	1.4	2.7	1.6	1.8	3.0	3.6	2.1	1.8	1.8	0.08
φ 100	2.2	4.8	1.9	3.0	5.1	6.6	3.8	4.2	3.3	0.18
φ 125	3.6	8.1	3.6	6.0	10.2	12.9	6.2	6.9	6.0	0.22
φ 150	6.2	13.5	5.1	8.4	16.2	20.4	10.9	10.8	9.6	0.57

Seating torque

Bore	φ 40, 50	φ 63	φ 80	φ 100	φ 125	φ 150
Bolt nut type	M10 × 1.25P	M12 × 1.5P	M16 × 1.5P	M18 × 1.5P	M22 × 1.5P	M26 × 1.5P
Seating torque (N · m)	42	56	120	160	330	570

TC

TS

RP

HC

HC_M

HCK

TH

DO

DX
DW

DM

DH

DK